

Engine & Cooling	Fuel	Ignition	Electrical	Running gear	Torque settings	Capacities	Notes & Illustrations
------------------	------	----------	------------	--------------	-----------------	------------	-----------------------



## Automotive Technical DATA BOOK

Click on one of the buttons above to view data for this car. To return to this screen and make another choice, click anywhere on the data screen.

MENU

HELP

### Engine and cooling system Alfa Sprint 1.7 1988 to 1989

Type		SOHC
Capacity (cm <sup>3</sup> ) / number of cylinders		1712 / 4
Compression ratio / pressure	bar	9.5 / 10.3
Oil pressure	bar	1.2 to 2.8
Oil temperature	°C	90
Valve clearance - inlet	mm	0: Hyd.
Valve clearance - exhaust	mm	0: Hyd.
Firing order		1-3-2-4
No 1 cylinder position		FR
Thermostat opening temperature	°C	84 to 88
Radiator cap pressure	bar	0.69

### Fuel system Alfa Sprint 1.7 1988 to 1989

Idle speed - manual [auto]	rpm	850 to 1000
Fast idle speed - manual [auto]	rpm	—
CO @ idle speed [3000 rpm] - see page VI	%	—
HC @ idle speed [3000 rpm] - see page VI	ppm	≤1200
CO <sub>2</sub> @ idle speed [3000 rpm] - see page VI	%	—
O <sub>2</sub> @ idle speed [3000 rpm] - see page VI	%	—
Carburettor / fuel injection		Weber/Dellorto
Type / ref		W: 40IDF. D: 2x36DRLA
Main jet / needle		140, 140
Injection pressure	bar	—
Pump pressure	bar	0.18 to 0.30
Octane rating	RON	98[E 95 RON]

### Ignition system Alfa Sprint 1.7 1988 to 1989

Type		Electronic
Ignition coil		Bosch. Marelli
Primary resistance	ohms	0.7 to 1.0
Ballast resistor	ohms	—
Voltage - Tmnl 15(+) to earth	V	—
Distributor		Bosch/Marelli
Points gap (air gap)	mm	[0.40 to 0.50]
Dwell angle	° (%)	—
Condenser capacity	µF	—
Rotation		Clockwise
Ignition timing - basic [static	° Crankshaft @ rpm	8±1 BTDC @ 900 (1st mark)
V = Vacuum NV = No Vacuum		NV
Total ignition advance	° Crankshaft @ rpm	—
	° Crankshaft @ rpm	36±1 BTDC @ 4500 (2nd mark)
	° Crankshaft @ rpm	—
Centrifugal check.	° Crankshaft @ rpm	0 @ 500 to 600
	° Crankshaft @ rpm	—
	° Crankshaft @ rpm	28 @ 3500 to 3600
Vacuum range check	mbar	200 to 373
Maximum vacuum advance	° Crankshaft	15
Spark plugs		Lodge/Champion
Type		25HL / N6YCC
Electrode gap	mm	Champion: 0.80

### Electrical system Alfa Sprint 1.7 1988 to 1989

Battery	V / CC / RC	12 / 45Ah
Alternator voltage / full load current / engine rpm		13.8 to 14.4 / _ / 4000
Starter motor current / voltage - cranking	A / V	200 to 230 / 9.8 to 10.0
- locked	A / V	380 to 400 / 8.0

### Running gear Alfa Sprint 1.7 1988 to 1989

<b>Brakes -</b>		
Front (min. friction material thickness)	mm	7.0 with backing
Rear (min. friction material thickness)	mm	7.0 with backing

<b>Tyres</b>		
Saloon	Size	185/60x14
Estate / Van	Size	—
Pressure - front / rear - Saloon	bar	1.8 / 1.6
- Estate / Van	bar	—

<b>Front suspension / wheel alignment</b>		
Toe-in (+) / Toe-out (-)	mm [°]	-4.0±2.0
Camber		-2°12'±30'
Castor		+1°±30'
King pin inclination		—

<b>Rear suspension / wheel alignment</b>		
Toe-in (+) / Toe-out (-)	mm [°]	0±2.5
Camber		0±25'

### Torque wrench settings Alfa Sprint 1.7 1988 to 1989

Cylinder head - stage 1	Nm	29 oiled
- stage 2	Nm	58
Cylinder head - stage 3	Nm	81 to 87
- stage 4	Nm	No.7: 20 to 24
Big-end bearings	Nm	43 to 48
Main bearings	Nm	66 to 73 oiled
Clutch cover	Nm	15 to 23
Flywheel [driveplate]	Nm	94 to 105 oiled
Front hubs	Nm	WSM
Rear hubs	Nm	WSM
Wheel nuts / bolts	Nm	64 to 78
Spark plugs	Nm	28

### Capacities Alfa Sprint 1.7 1988 to 1989

Engine oil & filter	litres	4.0
Gearbox - 4-speed [5-speed]	litres	3.4
Automatic transmission - refill	litres	—
Final drive	litres	WT
Cooling system	litres	7.3
Fuel tank	litres	50

### Notes and Illustrations



1: Idle speed 2: CO / Mixture

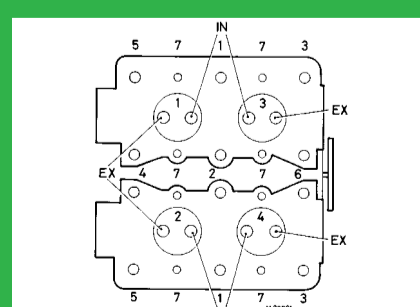

1712 cm<sup>3</sup>, 8V

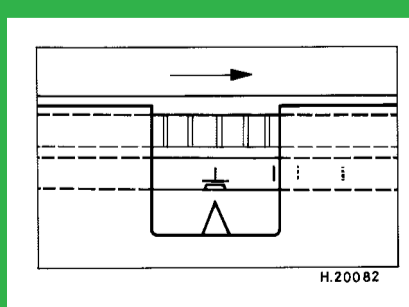

1712 cm<sup>3</sup> 8V

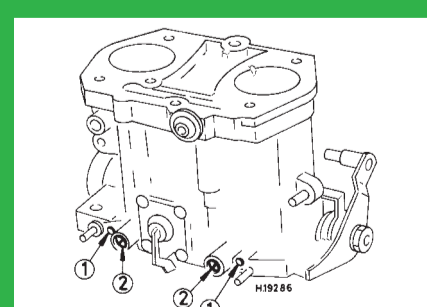

Dellorto 36 DRLA

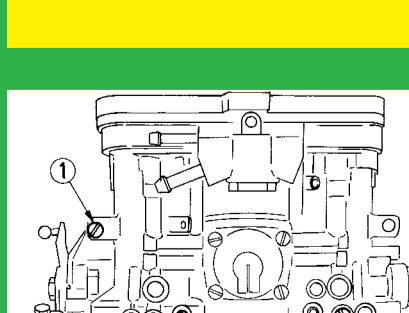

Weber 40 IDF