

Engine & Cooling	Fuel	Ignition	Electrical	Running gear	Torque settings	Capacities	Notes & Illustrations
------------------	------	----------	------------	--------------	-----------------	------------	-----------------------



Automotive Technical DATA BOOK

Click on one of the buttons above to view data for this car. To return to this screen and make another choice, click anywhere on the data screen.

MENU

HELP

Engine and cooling system ZX 1.1 1991 to 1992

Type	TU1/K (H1A) 44kW 15.04	
Capacity (cm ³) / number of cylinders	1124 / 4	
Compression ratio / pressure	bar	9.4 / _
Oil pressure	bar	[4.0]
Oil temperature	°C	90
Valve clearance - inlet	mm	0.20±0.05
Valve clearance - exhaust	mm	0.40±0.05
Firing order	1-3-4-2	
No 1 cylinder position	FE	
Thermostat opening temperature	°C	89
Radiator cap pressure	bar	1.4

Fuel system ZX 1.1 1991 to 1992

Idle speed - manual [auto]	rpm	750±50
Fast idle speed - manual [auto]	rpm	_
CO @ idle speed [3000 rpm] - see page VI	%	_
HC @ idle speed [3000 rpm] - see page VI	ppm	≤1200
CO ₂ @ idle speed [3000 rpm] - see page VI	%	≥10.0
O ₂ @ idle speed [3000 rpm] - see page VI	%	_
Carburettor / fuel injection	Solex	
Type / ref	32 PBISA 16 PSA411	
Main jet / needle	127.5	
Injection pressure	bar	_
Pump pressure	bar	0.25
Octane rating	RON	98[E 95 RON]

Ignition system ZX 1.1 1991 to 1992

Type	Electronic	
Ignition coil	Ducellier BTR 05	
Primary resistance	ohms	0.8
Ballast resistor	ohms	_
Voltage - Tmnl 15(+) to earth	V	_
Distributor	Bosch/Ducellier	
Points gap (air gap)	mm	_
Dwell angle	° (%)	_
Condenser capacity	µF	_
Rotation	Anticlockwise	
Ignition timing - basic [static	° Crankshaft @ rpm	8±2 BTDC @ 750
V = Vacuum NV = No Vacuum	NV	
Total ignition advance	° Crankshaft @ rpm	C041-D029
	° Crankshaft @ rpm	_
	° Crankshaft @ rpm	_
Centrifugal check.	° Crankshaft @ rpm	0 @ 1000 to 1400
	° Crankshaft @ rpm	12 to 16 @ 3000
	° Crankshaft @ rpm	18 to 22 @ 4400
Vacuum range check	mbar	140 to 410
Maximum vacuum advance	° Crankshaft	11 to 15
Spark plugs	Bosch/Champion	
Type	F7DCOR / C10YCC	
Electrode gap	mm	0.80 to 0.90

Electrical system ZX 1.1 1991 to 1992

Battery	V / CC / RC	(12L1 200, 12L1 250)
Alternator voltage / full load current / engine rpm	13.8 to 14.5 / 50 / 1800	
Starter motor current / voltage - cranking	A / V	105 / 12
- locked	A / V	220 / _

Running gear ZX 1.1 1991 to 1992

Brakes -		
Front (min. friction material thickness)	mm	2.0
Rear (min. friction material thickness)	mm	1.0
Tyres		
Saloon	Size	165/70x13
Estate / Van	Size	_
Pressure - front / rear - Saloon	bar	2.2 / 2.2
- Estate / Van	bar	_
Front suspension / wheel alignment		
Toe-in (+) / Toe-out (-)	mm [°]	0 to -2.0
Camber	+30'±30'	
Castor	+1°30'±30'	
King pin inclination	+10°45'±40'	
Rear suspension / wheel alignment		
Toe-in (+) / Toe-out (-)	mm [°]	-1.5 to +2.5
Camber	-1°±20'	

Torque wrench settings ZX 1.1 1991 to 1992

Cylinder head - stage 1	Nm	20
- stage 2	Nm	+ 240°
Cylinder head - stage 3	Nm	_
- stage 4	Nm	_
Big-end bearings	Nm	40
Main bearings	Nm	20 + 45°
Clutch cover	Nm	35
Flywheel [driveplate]	Nm	65 LkC
Front hubs	Nm	250
Rear hubs	Nm	140
Wheel nuts / bolts	Nm	90
Spark plugs	Nm	25

Capacities ZX 1.1 1991 to 1992

Engine oil & filter	litres	3.5
Gearbox - 4-speed [5-speed]	litres	2.0
Automatic transmission - refill	litres	_
Final drive	litres	WT
Cooling system	litres	6.5. A/C: 7.5
Fuel tank	litres	56

Notes and Illustrations

1: Idle speed 2: CO / Mixture

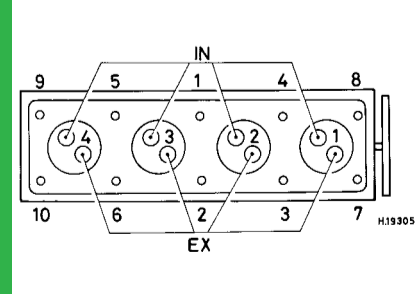

1124 cm³

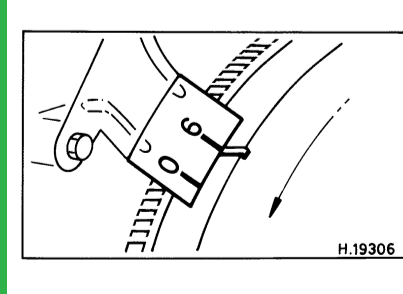

1124 cm³

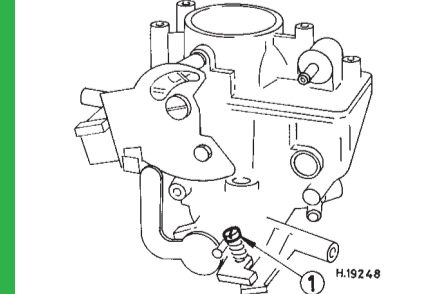

Solex PBISA

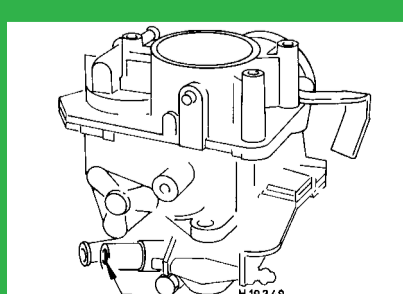

Solex PBISA