

Engine & Cooling	Fuel	Ignition	Electrical	Running gear	Torque settings	Capacities	Notes & Illustrations
------------------	------	----------	------------	--------------	-----------------	------------	-----------------------



Automotive Technical DATA BOOK

Click on one of the buttons above to view data for this car. To return to this screen and make another choice, click anywhere on the data screen.

MENU

HELP

Engine and cooling system C15E 1360 Van 1988 to 1991

Type		TU3A (K1G)
Capacity (cm ³) / number of cylinders		1360 / 4
Compression ratio / pressure	bar	9.3 / _
Oil pressure	bar	[4.0]
Oil temperature	°C	90
Valve clearance - inlet	mm	0.20
Valve clearance - exhaust	mm	0.40
Firing order		1-3-4-2
No 1 cylinder position		FE
Thermostat opening temperature	°C	87 to 89
Radiator cap pressure	bar	1.0

Fuel system C15E 1360 Van 1988 to 1991

Idle speed - manual [auto]	rpm	750±50
Fast idle speed - manual [auto]	rpm	_
CO @ idle speed [3000 rpm] - see page VI	%	≤0.5
HC @ idle speed [3000 rpm] - see page VI	ppm	≤300
CO ₂ @ idle speed [3000 rpm] - see page VI	%	_
O ₂ @ idle speed [3000 rpm] - see page VI	%	_
Carburettor / fuel injection		Solex
Type / ref		34 PBISA 17 Ref 481
Main jet / needle		132±2.5
Injection pressure	bar	_
Pump pressure	bar	0.25
Octane rating	RON	97[R]

Ignition system C15E 1360 Van 1988 to 1991

Type		Electronic - Hall effect
Ignition coil		Ducellier. Marelli. BTR 02
Primary resistance	ohms	0.8
Ballast resistor	ohms	_
Voltage - Tmnl 15(+) to earth	V	_
Distributor		Bosch/Ducellier
Points gap (air gap)	mm	_
Dwell angle	° (%)	_
Condenser capacity	µF	_
Rotation		Anticlockwise
Ignition timing - basic [static	° Crankshaft @ rpm	8±2 BTDC @ 700
V = Vacuum NV = No Vacuum		NV
Total ignition advance	° Crankshaft @ rpm	C057-D044
	° Crankshaft @ rpm	_
	° Crankshaft @ rpm	_
Centrifugal check.	° Crankshaft @ rpm	0 to 2 @ 1200
	° Crankshaft @ rpm	8 to 12 @ 3000
	° Crankshaft @ rpm	21 to 25 @ 5600
Vacuum range check	mbar	140 to 390
Maximum vacuum advance	° Crankshaft	13 to 17
Spark plugs		Eyquem/Champion
Type		FC52LS / C9YCX
Electrode gap	mm	0.80

Electrical system C15E 1360 Van 1988 to 1991

Battery	V / CC / RC	12 / 175 / 29
Alternator voltage / full load current / engine rpm		13.8 to 14.5 / _ / 3000
Starter motor current / voltage - cranking	A / V	47 / 12 (no load)
- locked	A / V	_

Running gear C15E 1360 Van 1988 to 1991

Brakes -		
Front (min. friction material thickness)	mm	2.0
Rear (min. friction material thickness)	mm	1.0

Tyres		
Saloon	Size	_
Estate / Van	Size	145x13
Pressure - front / rear - Saloon	bar	_
- Estate / Van	bar	2.3 / 2.8

Front suspension / wheel alignment		
Toe-in (+) / Toe-out (-)	mm [°]	+2.0
Camber		+37'±30'
Castor		+57'±30'
King pin inclination		+8°39'±30'

Rear suspension / wheel alignment		
Toe-in (+) / Toe-out (-)	mm [°]	+1.6 to 5.0
Camber		-9'±20'

Torque wrench settings C15E 1360 Van 1988 to 1991

Cylinder head - stage 1	Nm	20
- stage 2	Nm	+ 240°
Cylinder head - stage 3	Nm	_
- stage 4	Nm	_
Big-end bearings	Nm	40
Main bearings	Nm	20 + 45°
Clutch cover	Nm	10
Flywheel [driveplate]	Nm	65 LkC
Front hubs	Nm	250
Rear hubs	Nm	WSM
Wheel nuts / bolts	Nm	60 to 80
Spark plugs	Nm	25

Capacities C15E 1360 Van 1988 to 1991

Engine oil & filter	litres	3.5
Gearbox - 4-speed [5-speed]	litres	2.0
Automatic transmission - refill	litres	_
Final drive	litres	WT
Cooling system	litres	7.0
Fuel tank	litres	47

Notes and Illustrations

1: Idle speed 2: CO / Mixture

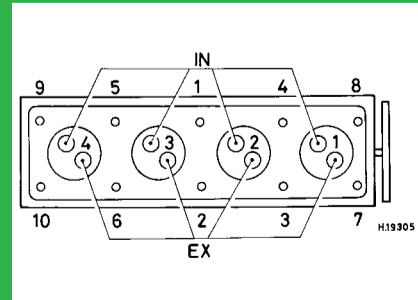

1360 cm³

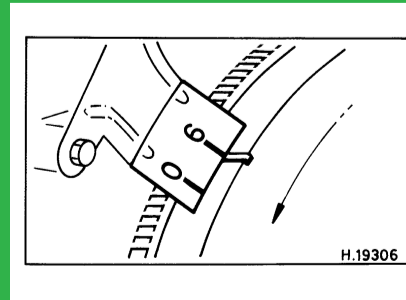

1360 cm³

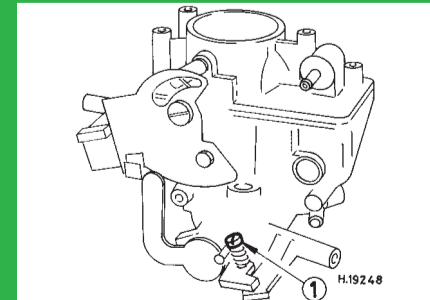

Solex PBISA

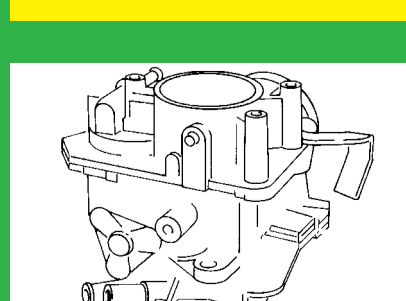

Solex PBISA