

Engine & Cooling	Fuel	Ignition	Electrical	Running gear	Torque settings	Capacities	Notes & Illustrations
------------------	------	----------	------------	--------------	-----------------	------------	-----------------------



Automotive Technical DATA BOOK

Click on one of the buttons above to view data for this car. To return to this screen and make another choice, click anywhere on the data screen.

MENU

HELP

Engine and cooling system Croma 2000 CHT 1989 to 1991

Type		154 C2.000 DOHC 8V 72kW
Capacity (cm ³) / number of cylinders		1995 / 4
Compression ratio / pressure	bar	9.5±0.15 / _
Oil pressure	bar	[3.4 to 4.9]
Oil temperature	°C	100
Valve clearance - inlet	mm	0.35±0.04
Valve clearance - exhaust	mm	0.40±0.04
Firing order		1-3-4-2
No 1 cylinder position		TBE
Thermostat opening temperature	°C	81 to 85
Radiator cap pressure	bar	0.98

Fuel system Croma 2000 CHT 1989 to 1991

Idle speed - manual [auto]	rpm	800±50
Fast idle speed - manual [auto]	rpm	_
CO @ idle speed [3000 rpm] - see page VI	%	1.5±0.5
HC @ idle speed [3000 rpm] - see page VI	ppm	≤1200
CO ₂ @ idle speed [3000 rpm] - see page VI	%	_
O ₂ @ idle speed [3000 rpm] - see page VI	%	_
Carburettor / fuel injection		Weber
Type / ref		34 DAT 55/150
Main jet / needle		95, 105
Injection pressure	bar	_
Pump pressure	bar	0.24 to 0.29
Octane rating	RON	98[E 95 RON]

Ignition system Croma 2000 CHT 1989 to 1991

Type		Digiplex 2
Ignition coil		Marelli BAE 504D
Primary resistance	ohms	0.405 to 0.495
Ballast resistor	ohms	_
Voltage - Tmnl 15(+) to earth	V	_
Distributor		Marelli
Points gap (air gap)	mm	_
Dwell angle	° (%)	_
Condenser capacity	µF	_
Rotation		_
Ignition timing - basic [static	° Crankshaft @ rpm	10±2 BTDC @ 500 to 1000
V = Vacuum NV = No Vacuum		_
Total ignition advance	° Crankshaft @ rpm	32±2 BTDC @ 5000
	° Crankshaft @ rpm	_
	° Crankshaft @ rpm	_
Centrifugal check.	° Crankshaft @ rpm	Computer control
	° Crankshaft @ rpm	_
	° Crankshaft @ rpm	_
Vacuum range check	mbar	Computer control
Maximum vacuum advance	° Crankshaft	_
Spark plugs		Bosch/Champion
Type		WR6DC / RN7YCC
Electrode gap	mm	0.85 to 0.95

Electrical system Croma 2000 CHT 1989 to 1991

Battery	V / CC / RC	12 / 210 / 65 (45Ah)
Alternator voltage / full load current / engine rpm		14.0 to 14.3 / 65, 70 / 3500
Starter motor current / voltage - cranking	A / V	270 / 9.2
- locked	A / V	_

Running gear Croma 2000 CHT 1989 to 1991

Brakes -		
Front (min. friction material thickness)	mm	1.5
Rear (min. friction material thickness)	mm	1.5
Tyres		
Saloon	Size	175/70x14: 195/60x14
Estate / Van	Size	_
Pressure - front / rear - Saloon	bar	175: 2.0 / 2.0 ¹
- Estate / Van	bar	_
Front suspension / wheel alignment		
Toe-in (+) / Toe-out (-)	mm [°]	-1.0 to +1.0
Camber		-20'±20'
Castor		+1°50' to 2°30'
King pin inclination		_
Rear suspension / wheel alignment		
Toe-in (+) / Toe-out (-)	mm [°]	+2.0 to 5.0
Camber		-20'±20'

Torque wrench settings Croma 2000 CHT 1989 to 1991

Cylinder head - stage 1	Nm	20
- stage 2	Nm	40
Cylinder head - stage 3	Nm	+ 90°
- stage 4	Nm	+ 90°
Big-end bearings	Nm	25 + 50°
Main bearings	Nm	20 ²
Clutch cover	Nm	20
Flywheel [driveplate]	Nm	142
Front hubs	Nm	450 locked ³
Rear hubs	Nm	320
Wheel nuts / bolts	Nm	86
Spark plugs	Nm	25 to 30

Capacities Croma 2000 CHT 1989 to 1991

Engine oil & filter	litres	5.5
Gearbox - 4-speed [5-speed]	litres	1.75
Automatic transmission - refill	litres	3.3
Final drive	litres	WT
Cooling system	litres	9.0
Fuel tank	litres	70

Notes and Illustrations

¹195: 2.2 / 2.2

²Centre bearing: + 120°. Others: + 80°

³Chassis no. 290 838 ▶: 360

1: Idle speed 2: CO / Mixture

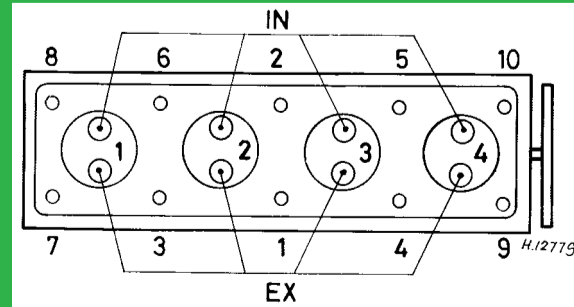

1995 cm³, 8V

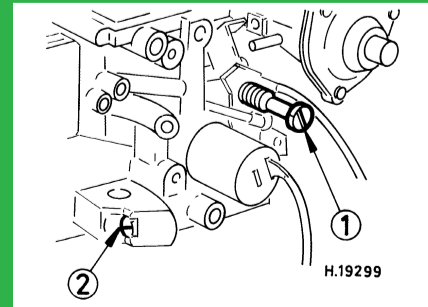

Weber DAT