

Engine & Cooling	Fuel	Ignition	Electrical	Running gear	Torque settings	Capacities	Notes & Illustrations
------------------	------	----------	------------	--------------	-----------------	------------	-----------------------



Automotive Technical DATA BOOK

Click on one of the buttons above to view data for this car. To return to this screen and make another choice, click anywhere on the data screen.

MENU

HELP

Engine and cooling system Nova / Corsa-A 1.2 1983 to 1993

Type		12ST/S12ST SOHC. 40kW. 15.04 ¹
Capacity (cm ³) / number of cylinders		1196 / 4
Compression ratio / pressure	bar	9.2 / _
Oil pressure	bar	1.5
Oil temperature	°C	80
Valve clearance - inlet	mm	0: Hyd.
Valve clearance - exhaust	mm	0: Hyd.
Firing order		1-3-4-2
No 1 cylinder position		TBE
Thermostat opening temperature	°C	92 to 107
Radiator cap pressure	bar	1.2 to 1.4

Fuel system Nova / Corsa-A 1.2 1983 to 1993

Idle speed - manual [auto]	rpm	900 to 950
Fast idle speed - manual [auto]	rpm	3600 to 4000
CO @ idle speed [3000 rpm] - see page VI	%	1.5±0.5 WSM
HC @ idle speed [3000 rpm] - see page VI	ppm	≤200
CO ₂ @ idle speed [3000 rpm] - see page VI	%	_
O ₂ @ idle speed [3000 rpm] - see page VI	%	_
Carburettor / fuel injection		Solex/Pierburg
Type / ref		1B1 9 276 983
Main jet / needle		105
Injection pressure	bar	_
Pump pressure	bar	0.25 to 0.36
Octane rating	RON	98[RA] ²

Ignition system Nova / Corsa-A 1.2 1983 to 1993

Type		TI-i
Ignition coil		Delco
Primary resistance	ohms	0.43
Ballast resistor	ohms	_
Voltage - Tmnl 15(+) to earth	V	_
Distributor		AC Delco
Points gap (air gap)	mm	_
Dwell angle	° (%)	Electronic control
Condenser capacity	µF	_
Rotation		Anticlockwise
Ignition timing - basic [static	° Crankshaft @ rpm	10±2 BTDC @ 900 to 950
V = Vacuum NV = No Vacuum		NV
Total ignition advance	° Crankshaft @ rpm	_
	° Crankshaft @ rpm	_
	° Crankshaft @ rpm	_
Centrifugal check.	° Crankshaft @ rpm	0 to 1 @ 1000
	° Crankshaft @ rpm	5 to 10 @ 1600
	° Crankshaft @ rpm	22 to 26 @ 4200
Vacuum range check	mbar	130 to 260
Maximum vacuum advance	° Crankshaft	12.5 to 16.5
Spark plugs		AC/Champion
Type		CR42CXLS / RN7YC
Electrode gap	mm	0.70 to 0.80

Electrical system Nova / Corsa-A 1.2 1983 to 1993

Battery	V / CC / RC	12 / 210 / 65 or / 175 / 60
Alternator voltage / full load current / engine rpm		13.7 to 14.75 / 45,55,65/ 3500
Starter motor current / voltage - cranking	A / V	50 / 11.5 (no load)
- locked	A / V	360 to 440 / 7.8 to 8.6

Running gear Nova / Corsa-A 1.2 1983 to 1993

Brakes -		
Front (min. friction material thickness)	mm	7.0 with backing
Rear (min. friction material thickness)	mm	0.5 above rivets

Tyres		
Saloon	Size	145x13: 155/70x13: 165/70x13 ³
Estate / Van	Size	145x13: 155/70x13
Pressure - front / rear - Saloon	bar	1.7 / 1.7
- Estate / Van	bar	1.7 / 1.7

Front suspension / wheel alignment

Toe-in (+) / Toe-out (-)	mm [°]	[-15' to +5']
Camber		-30' to +1° L
Castor		+45' to 2°45' L ⁴
King pin inclination		_

Rear suspension / wheel alignment

Toe-in (+) / Toe-out (-)	mm [°]	[-5' to +40] ⁵
Camber		-40' to -1°35' ⁶

Torque wrench settings Nova / Corsa-A 1.2 1983 to 1993

Cylinder head - stage 1	Nm	25 N
- stage 2	Nm	+ 60°
Cylinder head - stage 3	Nm	+ 60°
- stage 4	Nm	+ 60°
Big-end bearings	Nm	28 ⁸
Main bearings	Nm	50 +45° +15° N
Clutch cover	Nm	15
Flywheel [driveplate]	Nm	60 LkC
Front hubs	Nm	WSM
Rear hubs	Nm	WSM
Wheel nuts / bolts	Nm	110
Spark plugs	Nm	25

Capacities Nova / Corsa-A 1.2 1983 to 1993

Engine oil & filter	litres	3.0
Gearbox - 4-speed [5-speed]	litres	1.7 [1.8]
Automatic transmission - refill	litres	_
Final drive	litres	WT
Cooling system	litres	6.1
Fuel tank	litres	42

Notes and Illustrations

¹1990 ▶: 12NV. 38kW

²Retard ignition 3°. 89 ▶: [E 95 RON]

³165/65x14

⁴83 to 87: +30' to 2°30'

⁵83 to 87: [0 to +1°]

⁶83 to 87: 0 to -1°

⁸40mm bolt: 25 +30° N

1: Idle speed 2: CO / Mixture

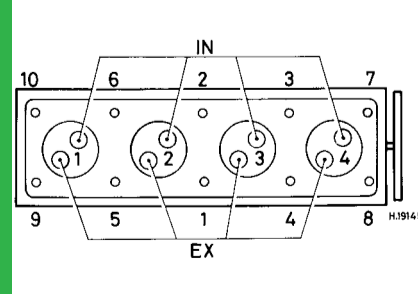

1196 cm³, SOHC

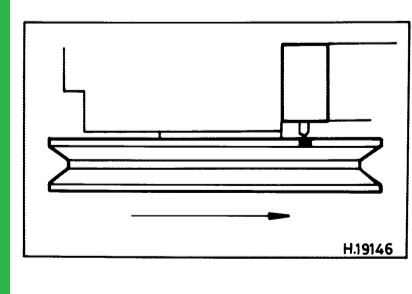

1196 cm³, SOHC

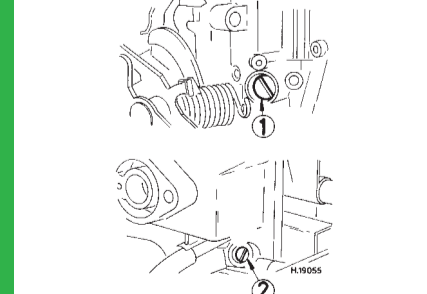

Solex /Pierburg 1B1