

Sears

MODEL 21
PUMP ACTION SHOTGUN
20 GAUGE



**Sears Guns are sold ONLY by Sears, Roebuck and Co.
and Simpsons-Sears Limited**

CLEANING AND LUBRICATING

Exclusive use of Sears ammunition practically eliminates any need for barrel cleaning. Should powder or any dirt accumulate in the barrel, however, it can easily be removed.

Periodically, dirt and fouling should be removed from the bolt, extractors and other operating parts. This should be done with a small brush soaked in solvent. Following this, these parts should be wiped dry and oiled lightly.

CAUTION

Check barrel for obstructions before loading and firing. Keep muzzle free from dirt, mud, water and snow or other objects which may find their way into the barrel when not in use.

NOTE: The choke on your plain barrel gun will be identified either by words, "Full," "Mod," or "Imp. Cyl" next to the chamber identification on the right side of the barrel or with asterisks on the left side of the barrel near the breech just above the forearm as follows:

One Asterisk (*) Full Choke.

Two Asterisks (**) Mod. Choke

Three Asterisks (***) Imp. Cyl. Choke.

CHOKE CONTROL ADJUSTMENTS

Turn the knurled sleeve clockwise as far as it will go. Then back off until the sleeve clicks and the word "FULL" lines up with the front sight. This shows that the CHOKE CONTROL is adjusted to throw the tightest choke pattern.

To decrease the degree of choke, unscrew the sleeve counterclockwise. The marking that appears opposite the front sight tells you the degree of choke, from "FULL" to "IMPROVED CYLINDER".

For shooting rifled slugs open choke to "IMPROVED CYLINDER" marking.

OPERATING INSTRUCTIONS

For trouble free operation clean heavy protective oils from your shotgun before firing. After cleaning, coat parts lightly with light gun oil. For protection, your shotgun also should be cleaned and oiled lightly after shooting and before storage. Also, with an adjustable choke gun, it is wise to turn choke cap to improved cylinder setting if you intend to store the gun for extended periods.

TO MAKE GUN SAFE: Safety is located in guard bow rearward of trigger. With hammer cocked push safety bar from left to right until red band is covered. This movement locks the trigger and gun cannot be fired. Always lock the trigger when carrying a loaded gun.

TO RELEASE SAFETY: Push safety from right to left exposing red band and gun is ready to fire.

TO LOAD CHAMBER: Open action fully by pulling back on forehand. If gun is locked, press in action slide release located in forward left side of guard bow. Drop shell in loading port and close action.

TO LOAD MAGAZINE: With the safety locking the trigger and the bolt closed, insert shells upward into bottom of the receiver and push forward into magazine tube past cartridge stops. Repeat until magazine is full. Magazine normally holds (4) shells or two with 5 $\frac{3}{4}$ inch plug in magazine.

TO OPERATE: When the gun is fired, the normal recoil of the gun automatically unlocks the action so that the forehand can be drawn fully back and then forward. If excessive rearward pressure is held on the forehand during firing, it will be necessary to release this pressure by a slight forward movement of the forehand before the action can be opened. The opening and closing action extracts and ejects the fired shell, cocks the hammer and carries a loaded shell into the chamber. The gun is now loaded and ready to fire. Always lock trigger with safety to prevent accidental firing.

TO REMOVE LOADED SHELL FROM CHAMBER WITHOUT FIRING: Push safety to "on" position. Press in action slide release button and open action slowly until shell is opposite ejection port. Place palm of your hand just over port opening, pull back on forehand and shell will drop out.

TO REMOVE LOADED SHELLS FROM MAGAZINE: Use same procedure for removing shell from chamber. Repeat until gun is empty.

PLUGGING MAGAZINE TO COMPLY WITH (3) SHOT GAME LAWS: Remove magazine cap (see disassembly instructions). Insert 5 $\frac{3}{4}$ inch wooden plug through center of magazine spring. Replace cap.

DISASSEMBLY

TO REMOVE TRIGGER GUARD ASSEMBLY: Remove butt plate from stock by removing (2) holding screws. With a long handled screw driver, loosen the stock bolt one or two turns to release tension on the trigger guard retaining pins. With the stock loosened, both the forward and rear trigger guard pins can be removed. The rear pin is in two parts. It may be necessary to hold one side with a screw driver while unscrewing the opposite side with another screw driver. The front pin is a solid pin and can be pushed out with a drift pin or suitable object. Remove the stock and trigger guard assembly by moving the stock to the rear and up. Be careful not to lose the hollow pin (action lock pin) located in the forward section of the trigger guard. It should not be necessary for further stripping of the trigger guard for normal cleaning.

TO REMOVE BREECH BOLT ASSEMBLY: Remove magazine cap using $\frac{1}{8}$ inch Allen wrench to remove the screw, recessed in magazine cap, being careful to hold back magazine spring which is under com-

pression. Pull forward on magazine tube and remove magazine tube, spring and follower. Holding gun with bottom of receiver upward and with bolt assembly approximately $\frac{1}{2}$ inch from the closed position, move the front end of the left hand cartridge stop approximately $\frac{1}{8}$ inch toward the center of the receiver (or enough to clear the action bar). Close and lock bolt. Pull forward and slightly upward on the forehand until the action bars clear the bolt assembly. Disassemble action bars from the forehand assembly. To remove bolt assembly, lift up the locking pin and slide bolt rearward until rear edge of the extractor just passes rear edge of ejection port of the receiver. With the index finger of the right hand on the face of the bolt and the thumb pushing the ejector to its forward limit, lift the rear of the bolt upward and rearward allowing the extractor to pass through the clearance provided.

TO ASSEMBLE: Reverse disassembly procedure.

NOTE: When replacing forehand and action bar assembly, it will be helpful to place the magazine tube inside the forehand far enough to retain the action bars on their respective pins (approximately flush with the rearward end of the forehand). When sliding action bars into receiver, be sure that the cartridge stop is held toward the center of the receiver as described in disassembly procedure. The action bars are not interchangeable from side to side. With the bottom opening of the receiver in an upward position, the bar with the cartridge stop cam angle fits the right hand side of the receiver with the cam angle upward.

CAUTION: When assembly or disassembly is performed correctly, it will not be necessary to use excessive force to move parts in or out of position.

LEFT HAND SAFETY INSTALLATION

REMOVE RIGHT HAND SAFETY 20750 AS FOLLOWS:

Hold the gun so that the trigger guard is in the up position.

To remove the **right hand** safety button, push the safety button to the fire position (red band showing). Using a small punch or wire (example: bent paper clip), insert wire thru hole provided in safety button. Depress safety plunger and at the same time apply slight pressure in the "FIRE" direction. Be careful not to lose the small spring-loaded safety plunger.

INSTALL LEFT HAND SAFETY 20761 AS FOLLOWS:

Insert the **left hand** safety button, with red band first, in hole in trigger guard until it butts against safety plunger. In this operation make sure the safety plunger detents are downward. While holding the safety plunger down, push the safety button over the plunger until the plunger drops into one of the detent notches.

A drop of oil on the plunger will assure a smooth working safety button.

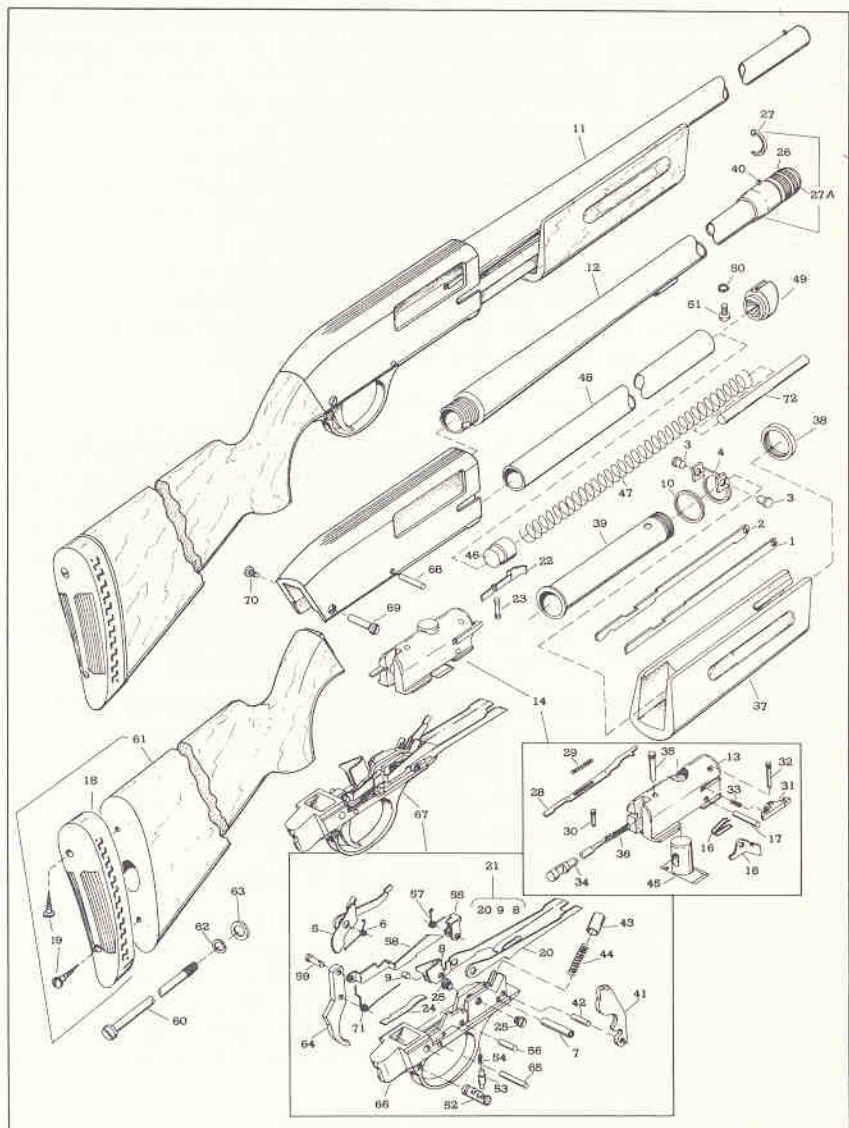

SPECIFICATIONS

Gauge	20	Barrel Length (inches)	26
Weight (lbs). Approximately	6	Pitch (inches)	1 3/8
Length of Pull (inches)	14	Stroke (inches)	3 1/2
Drop at Comb (inches)	1 3/8	Sight	Brass (Front)
Drop at Heel (inches)	2 1/4	Length (inches)	45 3/4

LIST OF PARTS AND ASSEMBLIES

Sears Model 21 20 Gauge, Identification number 583.2079. The identification number is on the left side of the barrel just forward of the receiver. Always mention this number when communicating with us regarding this pump action shotgun or when ordering parts.

HOW TO ORDER — Specify model number, identification number, part number and part name. When ordering barrels, specify choke desired.

Parts marked with a dagger must be fitted by gunsmiths in Sears mail order houses or by outside gunsmiths.

WHERE TO ORDER REPAIR PARTS — Any Sears retail or mail order store will handle your order.

REF. NO.	PART NO.	PART NAME	REF. NO.	PART NO.	PART NAME
1	20703	Action Bar, R. H.	38	20763	Forehand Retaining Nut
2	20702	Action Bar, L. H.	39	20728	Forehand Operating Tube
3	20704	Action Bar Pin (2)	40	130	Front Sight
4	20713	Action Bar Retaining Ring	41	†20730	Hammer
5	†20707	Action Lock	42	20733	Hammer Pin
6	20709	Action Lock Spring	43	20731	Hammer Plunger
7	20708	Action Lock Pin	44	20732	Hammer Spring
8	20710	Actuator	45	20781	Locking Pin Assembly
9	20711	Actuator Pin	46	20742	Magazine Follower
10	20706	Action Bar Adjustment Washer	47	20744	Magazine Spring
			48	20739	Magazine Tube
11	†20770	Barrel and Lug Assembly Plain (Specify Choke)	49	20740	Magazine Tube Cap
			50	20743	Magazine Tube Cap Retaining Screw Lock Washer
12	†20773	Barrel, Lug and Adj. Choke Assembly			
13	20758	Bolt	51	20741	Magazine Tube Cap Retaining Screw
14	†20783	Bolt Assembly			
15	20718	Bolt Cartridge Stop	52	20750	Safety Button, R. H.
16	20720	Bolt Cartridge Stop Spring	N.I.	20761	Safety Button, L. H.
17	20719	Bolt Cartridge Stop Pin	53	4044	Safety Plunger
18	6751	Recoil Pad	54	360	Safety Plunger Spring
19	152	Recoil Pad Screws (2)	55	†20745	Sear
20	20734	Cartridge Lifter	56	20747	Sear Pin
21	20784	Cartridge Lifter Assembly	57	20746	Sear Spring
22	20714	Cartridge Stop, L. H.	58	†20748	Sear Bar
23	20716	Cartridge Stop Retaining Pin, L. H.	59	20757	Sear Bar Pin
			60	666	Stock Bolt
24	20736	Cartridge Lifter Spring	61	20789	Stock Assembly
25	20735	Cartridge Lifter Screw (2)	62	667	Stock Bolt Lock Washer
26	11620	Choke Cap	63	668	Stock Bolt Washer
27	11633	Choke Click Spring	64	20756	Trigger
27A	20722	Choke Assembly	65	20749	Trigger Pin
28	20715	Exjector	66	20752	Trigger Guard
29	6720	Exjector Spring	67	20782	Trigger Guard Assembly
30	124	Exjector Retaining Pin	68	20760	Trigger Guard Retaining Pin
31	20755	Extractor			
32	124	Extractor Retaining Pin	69	20753	Trigger Guard Pin Rear
33	20723	Extractor Spring	70	20754	Trigger Guard Pin Screw
34	20724	Firing Pin	71	20759	Trigger and Sear Bar Spring
35	20725	Firing Pin Retaining Pin			
36	20726	Firing Pin Spring	72	685	Wood Plug 5/8"
37	20727	Forehand	N.I.	Not Illustrated	