

Reconstructed Manual for a

**PA-63**

Double Action – Semi-Automatic Pistol  
9x18mm Makarov

**More Gun Info can be found at:**

<http://Guninfo.tnet.com>

The contents of this manual were reconstructed from graphical  
Copies of the original and may be missing original content, may have  
misstated content or may contain information that is no longer valid,  
current or safe.

***Please use this information with caution and if necessary,  
contact the manufacture for a copy of the Real Manual.***



# **INSTRUCTIONS AND SAFETY MANUAL FOR PA-63 DOUBLE ACTION – SEMI AUTOMATIC PISTOL**

Even though you may be familiar or have had experience with other firearms, each firearm is different. In order to understand the basics of the PA-63, this manual should be read in its entirety. Enrollment in an NRA-approved safety course is encouraged if you are unfamiliar with firearms.

## **CAUTION**

Failure to heed the warnings in this booklet may result in serious injury to you or others, as well as damage to the firearm or other property.

Take note of the following warnings on gun handling before attempting to use your pistol.

- A. DON'T RELY ON YOUR GUN'S SAFETY, TREAT EVERY GUN AS IF IT WERE LOADED AND READY TO FIRE.
- B. NEVER CROSS A FENCE, CLIMB A TREE OR JUMP A DITCH WITH A LOADED GUN.
- C. NEVER LOAD OR CARRY A LOADED GUN UNTIL YOU ARE READY TO USE IT.
- D. WATCH YOUR MUZZLE SO THE OTHER FELLOW DOESN'T HAVE TO.
- E. KEEP GUNS AND AMMUNITION SEPARATELY AND IN LOCKED STORAGE.
- F. DON'T SHOOT UNLESS ABSOLUTELY SURE OF YOUR TARGET AND WHAT IS BEYOND IT.
- G. KNOW THE RANGE OF YOUR GUN
- H. ALWAYS WEAR EYE AND EAR PROTECTION WHEN SHOOTING
- I. ALWAYS BE SURE THE BARREL IS CLEAR OF OBSTRUCTIONS . . . AND ONLY USE CARE AMMUNITION SPECIFICALLY INTENDED FOR THE GUN YOU ARE USING.
- J. ALWAYS CARRY HANDGUNS WITH THE HAMMER DOWN ON AN EMPTY CHAMBER.

## **AMMUNITION SPECIFICATIONS**

<u>CALIBER</u>	<u>BULLET WEIGHT</u>
9mm Makarov (9x18mm)	95 grains

## **AMMUNITION WARNING**

Use only original, high quality, commercially manufactured ammunition which is in good condition. Only use ammunition of the caliber for which your pistol is chambered. You will find the correct caliber engraved on the slide of the barrel. Never use ammunition of any other caliber. You should always use ammunition that complies with performance standards established by The Sporting Arms and Ammunition Manufacturer's Institute, Inc.

The use of hand loaded, reloaded or other non-standard ammunition will void all warranties.

## **DISASSEMBLY**

The PA-63 pistol can be disassembled into 3 main components in a few seconds without any tools. No further disassembly is required or recommended for cleaning purposes. With the safety "ON", remove the magazine. Pull the trigger guard downward and to the side allowing it to rest on the frame. With the trigger guard held in this position, pull the slide all the way to the end of its travel. Lift the slide up and off of the frame and allow it to ease forward over the barrel. Note: Never let the hammer fall forward on the frame while the gun is dismantled. Damage may be done to internal parts.

The trigger guard may be replaced to its normal position after disassembly. The recoil spring may be removed for cleaning purposes (the Small end goes around the barrel).

## **ASSEMBLY**

With the safety "On" and the hammer cocked, pull the trigger guard downward and to the side allowing it to rest on the frame. Holding the trigger guard in this position, you can now replace the slide. Place the end of the recoil spring in the slide and pull the slide back to the end of its travel. Push it flat down on the frame allowing it to slide forward to its normal position on the frame. Return the trigger guard to its normal position.

## **OPERATION SAFETY**

The safety lever is on the left side of the slide. It is "ON" when the lever is turned down to cover the red dot; it is "OFF" when the lever is

turned up exposing the red dot. The safety lever locks the firing pin, shields the firing pin, and uncocks the hammer. (If it's already uncocked, keeps it from being cocked.).

Note: When the safety is placed on "ON" and the hammer is cocked, the hammer will drop forward, but cannot strike the firing pin. Keep your finger off the trigger and the muzzle pointed in a safe direction. To lower the hammer from the cocked position without letting it fall down in the normal fashion, with the right hand thumb, hold back the hammer and use the left hand to turn the safety lever "ON". Now ease the hammer down.

### **LOADING**

1. Remove the magazine by pressing the magazine release button.
2. Load the magazine by pushing down the feeder platform in the magazine with the rim of the shell and push it under the magazine shell guides. DO NOT USE FORCE! 7 Shells in clip maximum.
3. With the safety on "ON" and your fingers away from the trigger, chamber the first round. Place the full magazine into the pistol until it is held by its catch. Hold the pistol with the right hand; with the left hand, grasp the rear of the slide and pull the slide fully to the rear and release. The slide will snap forward chambering the first shell. Note: The hammer cannot be cocked until the safety lever is turned "OFF" exposing the red dot.

### **UNLOADING**

With the safety on "ON", remove the magazine. Pull back on the slide to eject any shells remaining in the chamber. Keep the slide held to the rear and check to make sure that the pistol is empty.

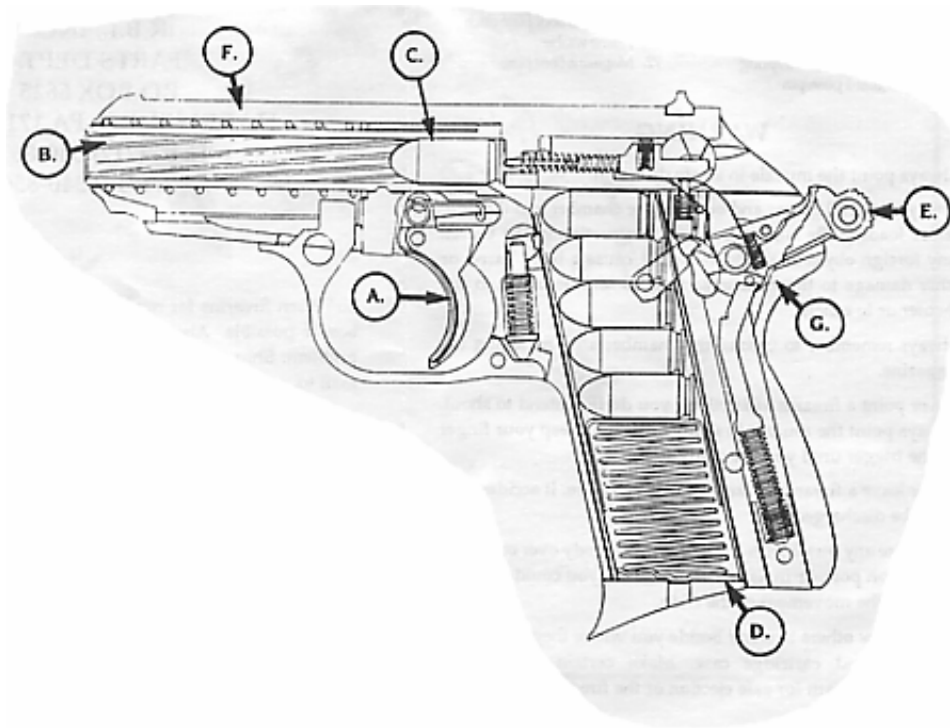

- |                         |           |
|-------------------------|-----------|
| A. TRIGGER              | D. HAMMER |
| B. BARREL               | E. SLIDE  |
| C. CARTRIDGE IN CHAMBER | F. FRAME  |

### **FIRING**

The double-action trigger operation of the PA-63 pistol offers a choice of 2 methods to cock the hammer for the first shot.

To shoot double-action, point the pistol at your target, push the safety "OFF" with your thumb, take aim and pull the trigger the full length of its travel. This will cock and drop the hammer in one motion, firing the pistol and recocking it for the next shot.

To shoot single-action, point the pistol at your target, push the safety "OFF" and cock the hammer fully to the rear. Keep your finger off the trigger while cocking the hammer! To shoot, pull the trigger. For each succeeding shot, the hammer is automatically cocked at the single position until the magazine is empty. The slid will remain fully to the rear after the last shot.

If you wish to continue shooting, remove the empty magazine and insert a full one. Keep your finger away from the trigger. Pull the

slide to the rear and release it. The slide will move forward to chamber the next round in the magazine.

If you wish to stop shooting after the first magazine is empty, turn the safety "ON" and remove the empty magazine. Pull the slide to the rear and allow it to run forward slowly uncocking the hammer.

## **CARE AND CLEANING**

Your pistol is delivered factory – packaged and preserved with a light coating of protective grease and oils. Before loading make certain that all packing grease and oil has been cleaned from the bore and exposed firing mechanisms.

## **PARTS LIST**

Important. When ordering please give the model of the pistol for which the part in question is required.

3	Frame	23	Hammer	48	Back sight
4	Barrel		Release lever	49	Nothing
5	Fixing pin to barrel and hammer spring housing	24	Nothing	50	Nothing
		25	Hammer pin	51	Nothing
		26	Nothing	52	Firing pin
		27	Hammer push pin	53	Firing pin spring
6	Sear push pin			54	Firing pin pressure spring
7	Sear push pin spring	28	Hammer spring		
		29	Hammer spring plug	55	Firing pin pressure spring sleeve
8	Sear push pin housing	30	Nothing		
9	Sear push pin housing pin	31	Magazine	56	Safety-Lever
		32	Magazine spring	57	Extractor Spring
10	Sear	33	Trigger Guard	58	Safety pin
11	Nothing		Pressure spring	59	Extractor pressure pin
12	Sear pin	34	Trigger Guard Push Pin	60	Extractor
13	Sear rod			61	Nothing
14	Trigger	35	Trigger Guard	62	Magazine body
15	Trigger spring	36	Trigger Guard Pin	63	Magazine platform
16	Trigger pin			64	Magazine spring
17	Nothing	37	Slide stop pin	65	Magazine floor late catch
18	Hammer	38	Slide stop		
19	Cocking Rod	39	Left-hand grip		
20	Cocking Rod pin	40	Right-hand grip		
21	Hammer cocking lever pin	41	Grip Screw	66	Nothing
		42	Grip Screw washer	67	Nothing
22	Pin to cocking rod and hammer push pin	43	Grip Screw nut	68	Nothing
		44	Recoil spring	69	Nothing
		45	Nothing	70	Nothing
		46	Nothing	71	Frame washer
		47	Slide	72	Magazine Floor plate

# PA-63 PARTS DIAGRAM

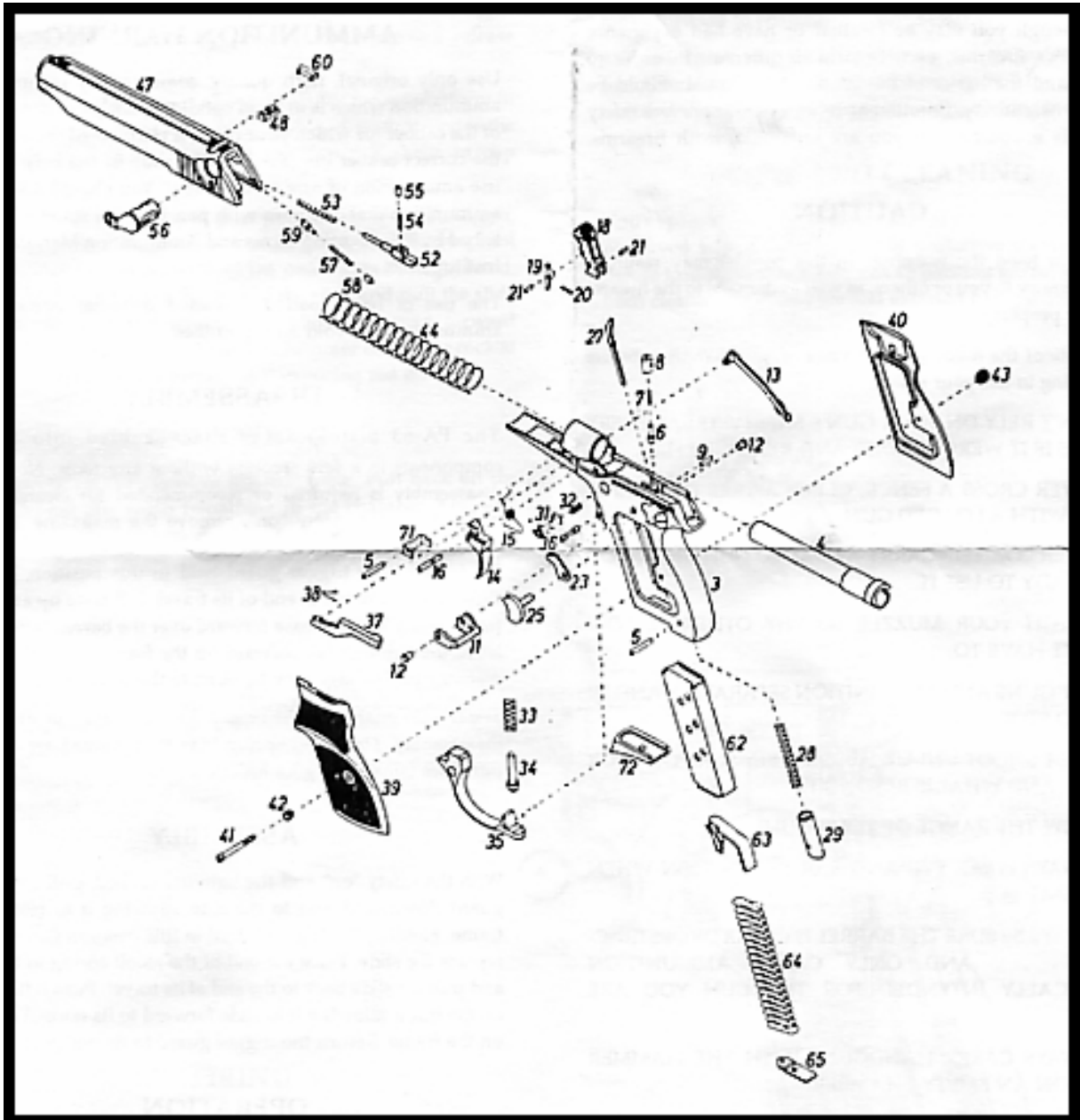

## **WARNING**

Always point the muzzle in a safe direction.

Always clean all the grease and oil from the chamber and the bore before loading. Be sure there is no obstruction in the barrel. Any foreign object in the barrel could cause a burst barrel or other damage to the firearm as well as injury to the shooter or others.

Always remember to unload the chamber after removing the magazine.

Never point a firearm at anything you do not intend to shoot. Always point the muzzle in a safe direction. Keep your finger off the trigger until you are ready to fire.

Never leave a firearm cocked and ready to fire. It accidentally could discharge.

Never fire any pistol with any part of your body over or next to the ejection port, or any position where you could possibly be hit by the movement of the slide.

Never allow others to stand beside you where they may be hit by an ejected cartridge case. Make certain there is an unobstructed path for safe ejection of the fired case.