



WINCHESTER[®]
RIFLES AND SHOTGUNS

Winchester[®] Wildcat[®] Bolt-Action Rifle Owner's Manual

GUN SAFETY WARNINGS

IT IS ESSENTIAL THAT THESE OPERATING INSTRUCTIONS BE THOROUGHLY STUDIED BEFORE USING THIS FIREARM TO ASSURE PROPER AND SAFE GUN HANDLING. FAILURE TO FOLLOW THESE INSTRUCTIONS OR FAILURE TO OBEY ANY SAFETY WARNING MAY RESULT IN INJURY TO YOURSELF OR OTHERS, OR CAUSE DAMAGE TO YOUR FIREARM.

As a gun owner, you accept a set of demanding responsibilities. How seriously you take these responsibilities can be the difference between life and death. There is no excuse for careless or abusive handling of any firearm. At all times handle your rifle and any other firearm with intense respect for its power and potential danger.

PLEASE READ AND UNDERSTAND ALL OF THE CAUTIONS, PROPER HANDLING PROCEDURES AND INSTRUCTIONS OUTLINED IN THIS OWNER'S MANUAL BEFORE USING YOUR NEW FIREARM.

1. Do not carry a loaded firearm with a live cartridge in the chamber while walking, running, climbing a tree, crossing a fence or anywhere you might slip or fall, drop the firearm or otherwise bump or jar the firearm. A firearm that is dropped, bumped or jarred with a chambered cartridge might accidentally discharge even with the safety on, causing serious injury or death to you or someone else. When you are ready to shoot and a cartridge is chambered, keep the safety on until shooting is imminent.
2. Do not rely on the safety to prevent accidental discharge. Many safeties merely block the trigger and prevent firing by pulling the trigger. The safety may not prevent an accidental discharge due to dropping, jarring or bumping a firearm.
3. Use only ammunition for which the firearm is chambered, as indicated on the barrel, to prevent excessive pressure and possible serious personal injury.
4. Incorrectly reloaded ammunition can cause serious personal injury and damage to the firearm due to excessive pressure. Reload only after proper instruction and in strict compliance with instruction and data contained in current reloading manuals.
5. Never point a firearm at anything you do not intend to shoot. Always keep it pointed in a safe direction in case of accidental discharge.
6. Always check to ensure that the barrel is free of obstructions before loading and using the firearm. If you experience light recoil or an off sound, check the barrel for an obstruction.
7. Before firing, clean any grease or oil out of the barrel with a cleaning rod and patch. Grease or heavy accumulation of oil can cause excessive pressures and result in serious personal injury.

8. Keep the barrel, chamber and action free of rust. Rust in the barrel and chamber can cause excessive pressures resulting in serious injury. A rusted, pitted or eroded barrel should be replaced.
9. Use hearing protection to prevent ear damage from repeated exposure to gunfire.
10. Always use proper shooting glasses to prevent eye injury from flying particles.
11. Never carry a loaded firearm in a motor vehicle or carry one into a dwelling. Always carefully unload the firearm before entering a motor vehicle, a dwelling or an area such as a camp. Always point firearms in a safe direction while loading or unloading to prevent serious injury in case of an accidental discharge. Never load your firearm in a house or in a vehicle.
12. Never shoot at a hard, flat surface or at the surface of water, to avoid a ricochet and possible serious personal injury to yourself or a bystander.
13. Store firearms in a clean, dry place out of reach of children and separated from stored ammunition.
14. Never alter any parts of your firearm. Any alterations or adjustments that may become necessary to the operating mechanism should be performed by a qualified gunsmith.
15. Hunting from elevated surfaces, such as tree stands, is dangerous. Doing so may increase the risk of handling any firearm. Always make certain that the stand being used is safe, sturdy and stable. Always make certain your firearm is unloaded when it is being taken up and down from the stand. Always make certain that your firearm is not dropped from the stand or dropped while it is being taken up or down from the stand.
16. Discharging firearms in poorly ventilated areas, cleaning firearms or handling ammunition may result in exposure to lead and other substances known to cause birth defects, reproductive harm and other serious physical injury. Have adequate ventilation at all times. Wash hands thoroughly after exposure.

GENERAL DESCRIPTION

The Winchester Wildcat is a bolt-action rifle capable of excellent accuracy. The Wildcat is ready for many years of service, plinking at the range or hunting small game. Study this owner's manual carefully to be sure you have covered all information about your new rifle.

Refer to Figure 1 for general part descriptions regarding your new rifle. You must become familiar with all part names listed before proceeding with the rest of the instructions in this owner's manual.

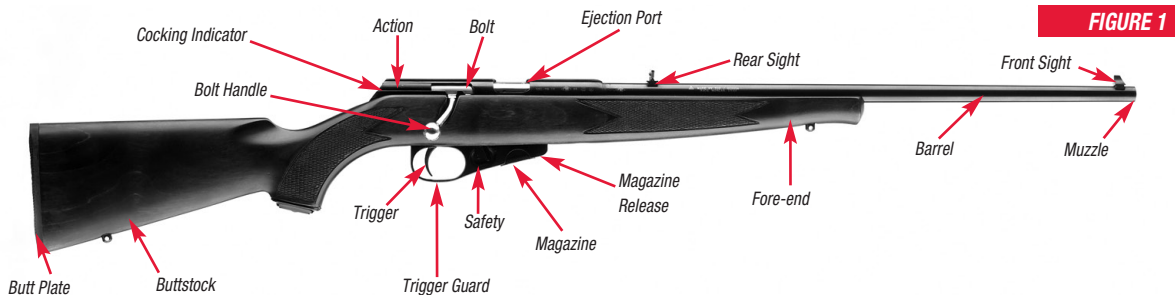

IMPORTANT: ALWAYS KEEP THE MUZZLE POINTED IN A SAFE DIRECTION. USE THE CORRECT AMMUNITION REFERENCED BY THE INSCRIPTION ON THE BARREL. BEFORE LOADING YOUR GUN BE SURE ALL GREASE AND OIL HAVE BEEN REMOVED FROM THE BARREL AND CHAMBER, AND THERE ARE NO OBSTRUCTIONS.

GENERAL OPERATION

The Wildcat is a bolt-action design that allows you to load a cartridge by cycling the action and moving a cartridge from a loaded magazine to the chamber. This can be repeated until the magazine is empty.

Prior to using live ammunition, familiarize yourself thoroughly with these operating instructions. Get accustomed to the feel of your new gun, know the forces required to operate the action. Learn how to pull the

trigger and, above all, know the location and operation of the safety. Procedures for disassembly and operation of various components are outlined in the sections in this owner's manual. Please read and study them thoroughly.

TERMINOLOGY AND DESCRIPTIONS

Descriptions in this owner's manual generally refer to the firearm in the horizontal position. That is, in the normal firing position. For example, the muzzle is forward or front; the buttstock is rearward or rear; the trigger is downward or underneath; the sights are upward or on top. For general parts terminology, refer to Figure 1. Figure 2 covers the general features and benefits of the Wildcat design.

Throughout this owner's manual, the "action" refers to the mechanism of this rifle which loads and secures the cartridge in the chamber.

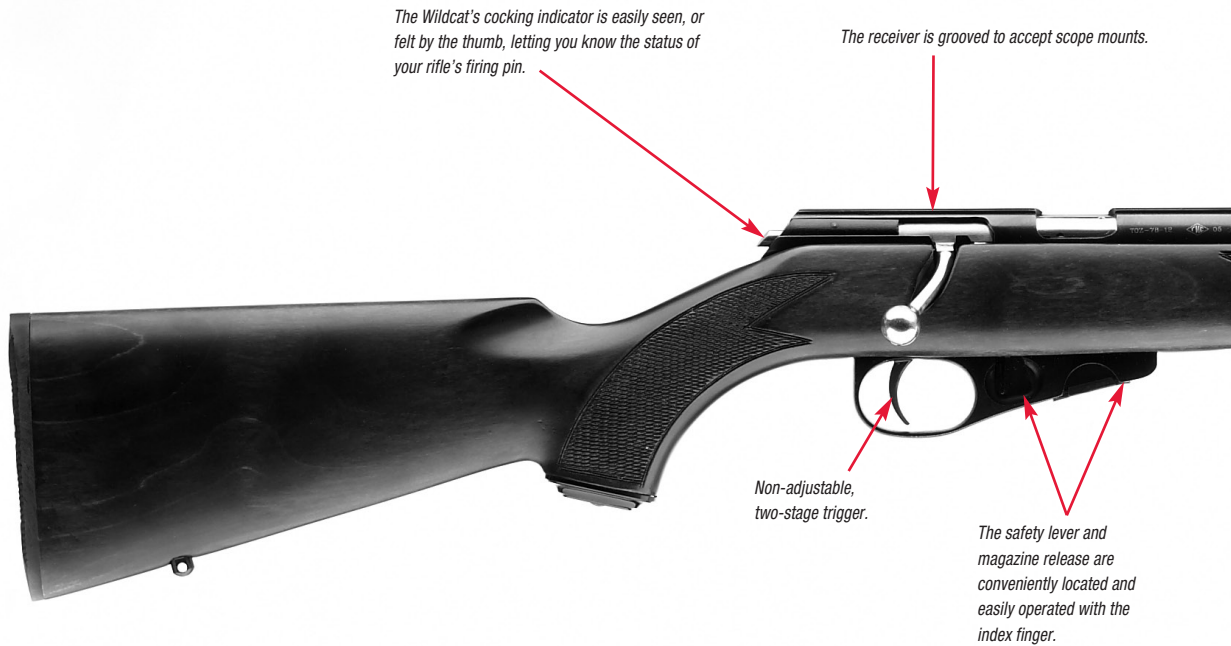

The Wildcat's cocking indicator is easily seen, or felt by the thumb, letting you know the status of your rifle's firing pin.

The receiver is grooved to accept scope mounts.

Non-adjustable, two-stage trigger.

The safety lever and magazine release are conveniently located and easily operated with the index finger.

FIGURE 2

The rear sight folds down for use with a scope.

The muzzle is target crowned to maintain accuracy.



The hardwood stock features bordered cut checkering, steel swivel studs, comfortable dimensions and a signature Schnabel fore-end.

10-round and 5-round magazines are included. Their slim, reliable design keeps the dimensions of the rifle narrow.



SERIAL NUMBER

The serial number is located on the left side of the receiver, forward of the ejection port. Record the serial number at the front of this owner's manual for future reference.

INITIAL CLEANING/OILING

Some metal parts of your new Wildcat rifle have been coated at the factory with a rust preventative compound. Before first using your Wildcat, a high-quality, light gun oil should be used to remove this compound and to give your new gun its first lubrication. Wipe the action and bolt clean and apply a few drops of quality oil on the bolt guide lug and guide rails. Clean the barrel using a cleaning rod and patch as explained under "Cleaning and Maintenance Suggestions" found on page 14 of this owner's manual. It is recommended that the "Cleaning and Maintenance Suggestions" be followed before each oiling.

If your new Wildcat is to be stored for an extended period of time, it is permissible to leave the rust preventative compound in place and keep your Wildcat in its box for maximum protection during long-term storage.

AMMUNITION

The Winchester Wildcat rifle must only be used with 22 Long Rifle rimfire ammunition as designated on the barrel.

Do not shoot 22 Short or 22 Long ammunition, blanks or bird shot cartridges. Always read the ammunition label and any enclosures with the ammunition to assure that the ammunition is appropriate or that there is no restriction for its use with your firearm. We can assume no responsibility for incidents which occur through the use of cartridges of nonstandard dimension or those developing pressures in excess of SAAMI (Sporting Arms and Ammunition Manufacturer's Institute) established standards.

Winchester ammunition is always an excellent choice for your new Winchester rifle, delivering the unmatched performance and dependability you want.

DISCHARGING FIREARMS IN POORLY VENTILATED AREAS, CLEANING FIREARMS OR HANDLING AMMUNITION MAY RESULT IN EXPOSURE TO LEAD AND OTHER SUBSTANCES KNOWN TO CAUSE BIRTH DEFECTS, REPRODUCTIVE HARM AND OTHER SERIOUS PHYSICAL INJURY. HAVE ADEQUATE VENTILATION AT ALL TIMES. WASH HANDS THOROUGHLY AFTER EXPOSURE.

OPERATION OF THE SAFETY

The safety is located just forward of the trigger guard, on the right side of the rifle.



1. "On Safe" — This is when the safety is moved to the most rearward position (Figure 3). **Always maintain the safety in this position when a cartridge is in the chamber or until shooting is imminent.**
2. "Off Safe" — With the safety fully forward, the rifle is ready to fire (Figure 4).

The safety mechanism when engaged is designed to prevent firing. However, this mechanism will not necessarily prevent the accidental discharge of this firearm as a result of jarring or abuse such as occurs when a firearm is dropped.

Never rely totally on your firearm's safety. It is merely an aid to safe gun handling. Like any mechanical device the safety can possibly fail; it can be bumped off or inadvertently manipulated into an unsafe condition. At all times, keep the safety in the "on safe" position and the barrel pointed in a safe direction. It is advisable to never load your rifle until you are in the field, at the location you intend to begin hunting or you are at your bench on a range and it is clear to shoot. For extra safety on a range, and as a courtesy to others, fully unload the rifle and keep the action in the open position at all times other than when it is clear to shoot.

IT IS ESSENTIAL THAT YOU BECOME FAMILIAR WITH THE FEEL, LOOK AND OPERATION OF THE SAFETY ON THIS RIFLE BEFORE ATTEMPTING TO LOAD IT AND SHOOT.

INSTALLING/REMOVING THE BOLT

The bolt of your rifle may have been packed separately in the carton in which your rifle is shipped. You will need to insert the bolt into the action. In addition, it is always advisable to remove the bolt before cleaning. Consequently, becoming familiar with removing and inserting the bolt assembly quickly and easily is absolutely essential.

FIRST INSTALLATION OF THE BOLT —

Before inserting the bolt into your rifle, make sure the firing pin is cocked and the safety is in the “off safe” position. Normally the bolt should be (and remain) cocked when removed from the rifle. When the firing pin is cocked, the cocking indicator is protruding from the bolt end cap a minimum of 1/8" (Figure 3). If the firing pin is not in the cocked position (cocking indicator not exposed), the bolt must be cocked prior to installation in the rifle.

To cock the bolt, first make sure the bolt end cap protrusion is in line with the firing pin guide (Figure 14, page 17). If it is not, rotate the bolt cap clockwise approximately 80°. With your left hand, grasp the front

of the bolt securely. Grasp the bolt handle with your right hand and rotate the bolt handle counterclockwise until the bolt handle is inline with the protrusion on the bolt cap.

IMPORTANT: FULLY UNLOAD YOUR RIFLE. BE CERTAIN THERE ARE NO CARTRIDGES IN THE CHAMBER AND THE MAGAZINE IS REMOVED PRIOR TO INSTALLING OR REMOVING THE BOLT.

BOLT INSTALLATION —

1. Place the safety in the “off safe” position.
2. Hold the trigger to the rear and insert the bolt into the receiver with the lugs on the bolt aligned with the lug tracks.
3. Release the trigger and push the bolt fully forward. Lower the bolt handle down to a locked position. The safety can now be operated.

BOLT REMOVAL —

1. To remove the bolt, unload the rifle, remove the magazine and point the muzzle in a safe direction.
2. Place the safety in the “off safe” position.
3. Raise the bolt handle and draw the bolt fully to the rear until it stops.
4. Hold the trigger to the rear and remove the bolt.



COCKING INDICATOR

When the firing pin is cocked, an indicator is visible at the rear of the bolt (Figure 5). If the indicator is protruding from the bolt sleeve a minimum of $\frac{1}{8}$ ", the firing pin is cocked.

MAGAZINE CAPACITY

Four magazines are included with your Wildcat rifle. There are two types: 10-round capacity and 5-round capacity (Figure 6). Remember, "total" capacity includes an additional cartridge which can be loaded in the chamber in addition to a full magazine.



LOADING

REMOVING AND LOADING THE MAGAZINE —

BE SURE THE SAFETY IS IN THE "ON SAFE" POSITION AND THE MUZZLE IS POINTED IN A SAFE DIRECTION.

1. Open the bolt to check the status of the rifle. If the chamber is loaded, it is recommended that you draw the bolt rearward and eject the cartridge. Remove the magazine as explained below and close the bolt. If the chamber is empty, close the bolt.
2. Press the magazine release button located underneath the rifle, just in front of the magazine, with the index finger of your free hand (Figure 7). The magazine will drop into your hand.



2. Insert the cartridges base first into the magazine and slide them all the way to the rear, so the bases are flush with the rear of the magazine (Figure 8). If the nose of a cartridge protrudes beyond the front of the magazine, it could cause feeding problems or interfere with the insertion of the magazine into the rifle. Continue to load the magazine until it is full.
3. After loading the magazine, insert it into the magazine well of the rifle until it is retained by the magazine latch. The bolt may now be cycled at any time you wish to load a cartridge into the chamber. **REMEMBER, NEVER CHAMBER A CARTRIDGE OR MOVE THE SAFETY FROM THE "ON SAFE" POSITION UNLESS SHOOTING IS IMMINENT.**

LOADING TO FULL CAPACITY —

1. If you wish to load a cartridge into the chamber after loading and inserting the magazine, draw the bolt back to the fully rearward position. **MAKE SURE THE SAFETY IN THE "ON SAFE" POSITION.** Then push the bolt fully forward to the locked, closed position, chambering a cartridge.
2. Remove the magazine and refill the magazine to capacity as previously described.
3. Insert the reloaded magazine. The magazine may be removed at any time for reloading.

SINGLE SHOT LOADING AND FIRING —

If you wish to use your Wildcat as a single-shot rifle, as when teaching a newcomer to the sport how to shoot, it is recommended that you use the following single-shot loading procedure.

1. Remove the magazine from the rifle as explained on pages 9 and 10.
2. Pull the bolt rearward and inspect the chamber to make sure that it is empty.
3. Close the bolt and place the safety in the “on safe” position.
4. Load a single cartridge into the magazine.
5. Insert the magazine into the rifle.
6. When ready to shoot, cycle the bolt to load the single cartridge from the magazine into the chamber.
7. Move the safety to the “off safe” position, take aim and squeeze the trigger to fire the rifle.
8. **REMEMBER, NEVER CHAMBER A CARTRIDGE OR MOVE THE SAFETY FROM THE “ON SAFE” POSITION UNLESS SHOOTING IS IMMINENT.**

FIRING

1. Insert a cartridge into the chamber as explained previously. Move the safety to the “on safe” position.

2. With a cartridge in the chamber, you need only move the safety to the “off safe” position to make the rifle ready for firing. **DO NOT MOVE THE “SAFETY” TO THE “OFF SAFE” POSITION UNTIL SHOOTING IS IMMINENT.**
3. Take aim and squeeze the trigger to fire the rifle.
4. After a cartridge has fired, cycle the bolt to eject the spent case and to chamber another cartridge.
5. After the last cartridge has been fired, or when shooting is no longer imminent, **PLACE THE SAFETY IN THE “ON SAFE” POSITION.** Follow the previous instructions on “Loading” if you wish to shoot again. If you are finished shooting, follow the instructions below for unloading your rifle.
6. **REMEMBER, NEVER CHAMBER A CARTRIDGE OR MOVE THE “SAFETY” FROM THE “ON SAFE” POSITION UNLESS SHOOTING IS IMMINENT.**

UNLOADING

UNLOADING THE CHAMBER —

1. **WITH THE MUZZLE POINTED IN A SAFE DIRECTION AND THE SAFETY IN THE “ON SAFE” POSITION,** press the magazine release button to remove the magazine.
2. Draw the bolt to its rear or open position. This will extract and eject any live cartridge that may be in the chamber. **AS A GOOD SAFETY PRACTICE, ALWAYS**

VISUALLY INSPECT THE CHAMBER TO BE ABSOLUTELY SURE A LIVE CARTRIDGE IS NOT PRESENT.

3. With the magazine removed and the chamber empty, the bolt may be closed. The magazine can then be either kept loaded and separate from the rifle or inserted back into the rifle if shooting is to continue, or the cartridges may be removed from the magazine by sliding them forward one by one and out of the front of the magazine.

IN THE CASE OF A MISFIRE

Only rarely will modern factory ammunition experience a misfire. If this ever occurs when shooting your Wildcat rifle, follow these instructions carefully.

CAUTION: IN CASE OF MISFIRE, KEEP THE MUZZLE POINTED IN A SAFE DIRECTION AND CAREFULLY OPEN THE ACTION WHILE AVOIDING DIRECT EXPOSURE TO THE BREACH BY YOURSELF AND OTHERS. REMOVE THE CARTRIDGE FROM THE CHAMBER. LEAVE THE ACTION OPEN AND REMOVE THE MAGAZINE.

Carefully inspect the ejected cartridge. If the primer is indented, the cartridge should be disposed of in a manner that would prevent accidental injury to you or others. If there is no indentation, your gun has malfunctioned and should be serviced by a qualified gunsmith, or by a

Winchester Rifles and Shotguns Authorized Repair Center (ARC) (page 19).

SIGHT ADJUSTMENTS

Wildcat rifles have a rear sight that can be folded forward so that it will not interfere with the line of sight and/or mounting of a scope. This allows you to mount a scope lower.

The proper sighting-in procedure is to shoot a group with the sights set as they come from the factory (intermediate position on both elevation and windage), and then make incremental adjustments to move the rear sight blade and blade holder to properly center the group on your target.

BEFORE MAKING ANY SIGHT ADJUSTMENTS, MAKE SURE THE MUZZLE IS POINTED IN A SAFE DIRECTION, YOUR RIFLE IS FULLY UNLOADED AND THE SAFETY IS IN THE "ON SAFE" POSITION.

UP OR DOWN ELEVATION ADJUSTMENTS —

Adjusting your rifle to shoot higher requires you to raise the notch on your rifle's rear sight. This is accomplished by first loosening the screws on the elevation adjustment and then moving the rear sight blade (the part with the rear notch) upward (Figure 9). Use your fingers to lift it up, then retighten the screws. Marked index lines give you a reference as you adjust the sight. Adjusting the sight to

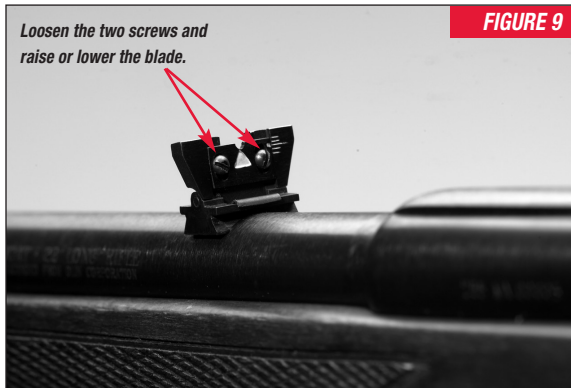

make your rifle shoot lower is just the opposite — move the sight blade down. Remember:

- Move the blade up to shoot higher.
- Move the blade down to shoot lower.

RIGHT OR LEFT WINDAGE ADJUSTMENTS —

The rear sight base is dovetailed into the barrel of the rifle. To adjust for windage, move the rear sight base to the right or left by tapping the dovetailed base using a wood or fiber dowel or hammer that will not mar the sight base (Figure 10). If you tap the rear sight base to the right your gun will shoot more to the right. Moving the rear

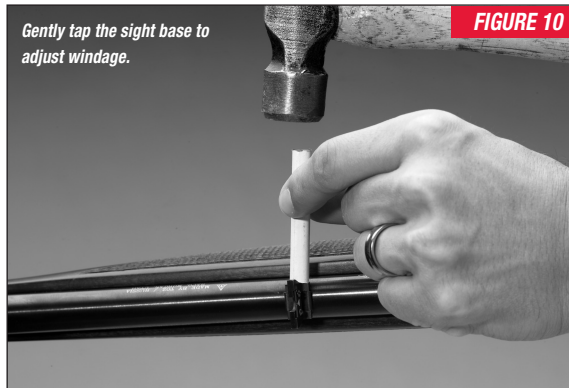

sight base to the left is just as easily done. Note how much you adjust the sight as you sight-in your rifle. Remember:

- Move the rear sight to the right to shoot farther to the right on the target.
- Move the rear sight to the left to shoot farther to the left on the target.

Care should be taken not to mar the finish, damage the attaching screws or bend sight components when adjustments are made.

The front sight blade is also held in a dovetail mount on the sight base. It is possible to make windage adjustments by tapping it to one side or the other, like

the rear sight base. When adjusting the front sight you get the opposite results:

- Move the front sight blade to the right to shoot more to the left.
- Move the front sight blade to the left to shoot more to the right.

All sight adjustments — of course — are a matter of trial and error. Remember, it is usually necessary to reset your sights when you change type or even brand of ammunition.

MOUNTING A SCOPE

The receiver of your Wildcat rifle is grooved for standard $\frac{3}{8}$ " nominal rimfire scope rings. See your Winchester Rifles and Shotguns dealer to purchase the rings designed for this mounting system and the scope you intend to use.

CLEANING AND MAINTENANCE SUGGESTIONS

Your Wildcat rifle will function better and more reliably over a longer period of time if it is properly maintained and kept clean.

BEFORE PERFORMING ANY CLEANING PROCEDURES, ALWAYS MAKE CERTAIN YOUR RIFLE IS COMPLETELY UNLOADED, THERE ARE NO CARTRIDGES IN THE

CHAMBER, ACTION/FEED AREAS AND THE MAGAZINE IS REMOVED.

You should clean your Wildcat after every day of shooting and more often if it becomes excessively dirty.

A minimum cleaning includes wiping down the action and oiling key parts. Most regular maintenance will also include cleaning the barrel. If you encounter a function problem (tight action when working the bolt), be sure to give your gun a thorough cleaning to see if it solves the problem before seeking the services of our service facility or a qualified gunsmith.

BE CERTAIN YOUR GUN'S CHAMBER IS UNLOADED AND THE MAGAZINE IS REMOVED. ALWAYS WEAR PROTECTIVE SAFETY GLASSES DURING ALL CLEANING PROCEDURES. KEEP AMMUNITION AWAY FROM THE CLEANING AREA. DO NOT TEST THE FUNCTION OF YOUR FIREARM WITH LIVE AMMUNITION.

CLEANING SUGGESTIONS —

Always place the safety in the “on safe” position before beginning any cleaning procedure.

1. Remove the bolt from your rifle as explained on page 9.
2. Use a cleaning rod with a tip and patch suitable for a 22 caliber rifle. Make sure the patch is large enough for a snug fit in the bore. Insert the rod and patch into

the barrel at the receiver end and run it back and forth several times. NOTE: Use a crown protector if you are cleaning from the muzzle end of the barrel. Damage to the crown of a barrel can affect the accuracy of your rifle.

3. Inspect the chamber and bore for powder fouling. A normal amount of powder residue can be expected and is not serious. It can usually be removed by repeating step 2, using a patch saturated with solvent. If, or when, fouling should become heavy, it can be removed with a brass bore brush. Dip or spray the brush with solvent and scrub the chamber and bore until the fouling is removed. To prevent brass bristles from breaking off, the brush should be pushed completely through the bore before being withdrawn.
4. After fouling has been removed the bore should be wiped dry. Then pass a lightly oiled patch through the bore for preservation. A fine, light gun oil is recommended.
5. Wipe all exposed metal surfaces of the receiver, forearm and barrel with a clean rag. Finger marks should be removed because they provide a place where moisture can accumulate. Any dried oil in the receiver area should also be removed.
6. Lightly oil the bolt guide lugs and guide rails. Ordinary good judgment will, of course, indicate that the metal of the gun should receive a light film of oil any time the

rifle has been exposed to weather or handling. This is very important and must be done with every firearm. Remember, the fitted surfaces of the receiver and action mechanisms must always have a thin film of oil. Make sure that the surfaces of the breech bolt are especially clean and lightly oiled with a high quality gun oil. Do not use pure silicone or lanolin.

7. Inspect the barrel and chamber. Make certain that no patches have been inadvertently left in them. Remove any that remain.
8. Wipe all wood surfaces with a lightly oiled cloth.
9. When transporting your rifle, store it in a quality protective case to prevent scratches and dents. Store your rifle in a dry place to prevent corrosion. Store your rifle and ammunition separately, away from children.

MAKE SURE YOUR RIFLE IS UNLOADED AND ALWAYS STORE AMMUNITION SEPARATELY.

OTHER CLEANING SUGGESTIONS —

- Never pour large quantities of oil into the receiver or other parts of your rifle. It can drain down into the wood and soften it, causing permanent damage and loosening of the stock.
- After extended periods of heavy use, your gun should be taken to a qualified gunsmith to have the action disassembled for professional cleaning and lubrication.

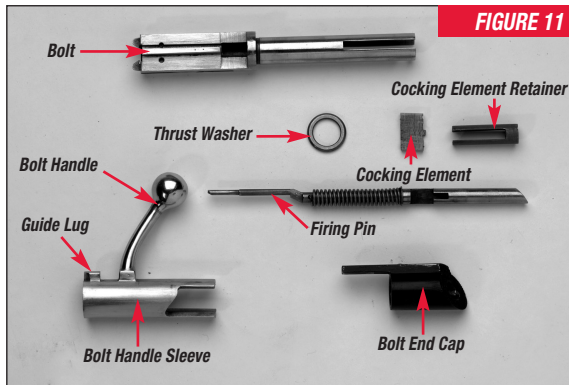

NEVER ATTEMPT TO TAKE YOUR WILDCAT RIFLE APART FURTHER THAN EXPLAINED IN THIS OWNER'S MANUAL.

Your rifle is a specialized, finely fitted mechanism. You may permanently mar it by attempting to disassemble the inner mechanism assemblies. If further disassembly for service or cleaning is required, take your gun to a Winchester Rifles and Shotguns Authorized Service Center or a qualified gunsmith as explained under “Parts, Service, Repair and Questions” on page 19.

BOLT MAINTENANCE

The bolt of the Wildcat rifle is easily fieldstripped for cleaning and maintenance (Figure 11).

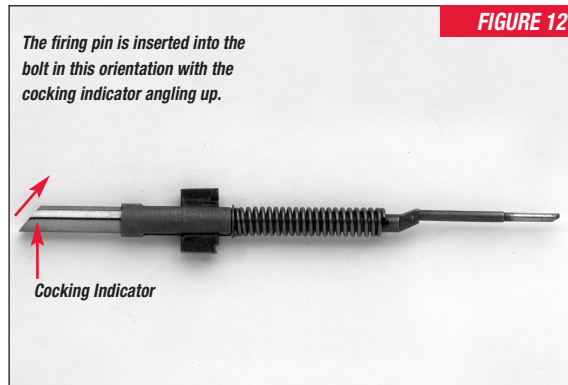

Make sure you have a clean place to work and lay out the bolt components in order as they are disassembled. Disassembling the bolt can be done in the field, but remember, there are small parts involved.

IMPORTANT: COMPLETELY UNLOAD YOUR RIFLE. BE CERTAIN THERE ARE NO CARTRIDGES IN THE CHAMBER AND THE MAGAZINE IS REMOVED PRIOR TO INSTALLING OR REMOVING THE BOLT. BE SURE TO USE EYE PROTECTION WHENEVER DISASSEMBLING THE BOLT DUE TO SPRING-TENSIONED PARTS.

DISASSEMBLY —

1. Remove the bolt as explained previously.

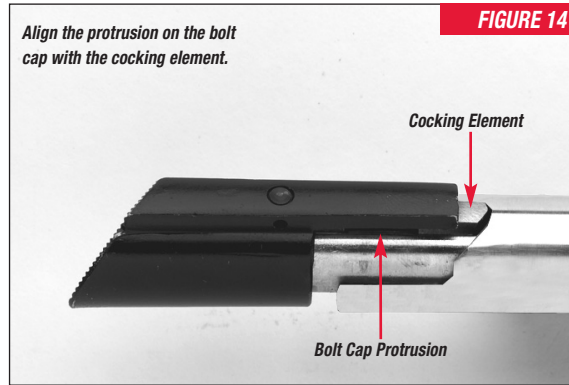
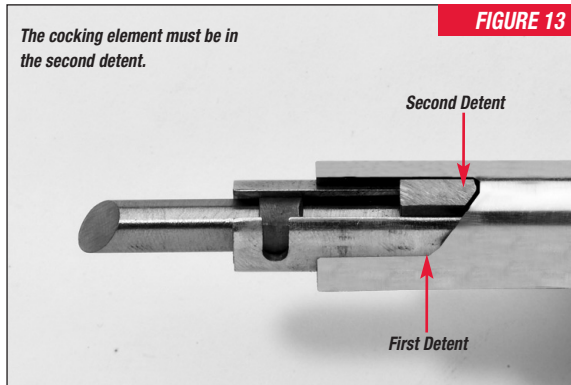

2. Hold the bolt in your left hand, with your thumb bracing the bolt handle.
3. Grasp the bolt end cap with your right hand and rotate it fully counterclockwise, approximately 60°. Remove the bolt end cap to the rear.
4. Grasp the cocking indicator and pull rearward to remove the firing pin. Note the orientation of the firing pin as it is crucial to have it positioned the same way during reassembly. It is not necessary or recommended that you disassemble the firing pin assembly beyond what is shown in Figure 11.
5. Slide the bolt handle sleeve rearward and off the bolt. The bolt is now disassembled to the extent necessary to

perform cleaning and lubrication. A light coat of oil or grease on the bolt, including the bolt lug and guide rails is all that is necessary to lubricate the bolt. Do not disassemble the bolt beyond what is shown in Figure 11.

REASSEMBLY —

1. With the top of the bolt up, make sure the thrust washer is installed on the bolt and slide the bolt handle sleeve, with the guide lug forward, onto the bolt so the handle is on the right side of the bolt.
2. Insert the firing pin assembly into the rear of the bolt. Orient the pin as shown in Figure 12. The cocking element must be in the secondary detent in the bolt handle sleeve as shown in Figure 13.

- Place the bolt cap over the end of the bolt, so that the protrusion is aligned with the cocking element (Figure 14). Hold the bolt securely and push in on the bolt cap while rotating it clockwise approximately 80°.
- With your left hand, grasp the front of the bolt securely. Grasp the bolt handle with your right hand and rotate the bolt handle counterclockwise until the bolt handle is aligned with the protrusion on the bolt cap.
- Reinstall the bolt in the action as explained previously.

MAGAZINE MAINTENANCE

The Wildcat magazine is highly reliable and easy to clean and maintain. Disassembly takes just a few seconds and should be a normal part of your rifle's maintenance. Component parts are designed for ease of disassembly and reassembly. This gives you extra confidence when conducting maintenance in the field.

DISASSEMBLY —

- BE SURE TO USE EYE PROTECTION WHENEVER DISASSEMBLING THE MAGAZINE DUE TO SPRING-TENSIONED PARTS.** Release the floor plate from the magazine by pressing on the release button through the hole in the bottom of the floor plate. The button is simply a protrusion on the floor plate catch that engages in the floor plate under pressure from the

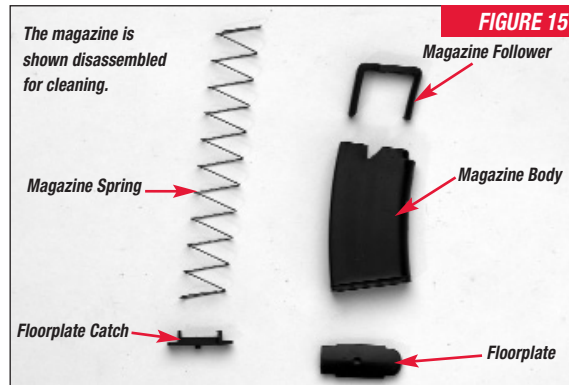

- magazine spring. Use a punch or other suitable object to disengage it.
- With the button depressed, slide the floor plate off of the rails toward the front of the magazine.
- Be prepared to retain the spring, as it is under tension and may spring out unless controlled. Slowly remove the spring and follower from the magazine body.
- Do not attempt to disassemble beyond this point (Figure 15).
- Clean the magazine components using a plastic-safe solvent and lightly oil all components with a plastic-safe lubricant.

MAGAZINE REASSEMBLY —

1. Insert the follower with the rounded edge to the front of the magazine.
2. Insert the spring assembly.
3. Place the floorplate catch on the spring. Make sure the rounded edge of the floorplate catch is to the front.
4. Compress the spring until the floorplate catch is flush with the bottom of the tube.
5. Hold the floorplate catch down inside the magazine with one hand while you slide the floorplate onto the rails, starting the floorplate at the front of the magazine body and sliding it rearward, until the floorplate catch snaps into position. The shape of the floorplate corresponds to the shape of the floorplate catch and the shape of the bottom of the magazine body, rounded edges to the front, flat edges to the rear. A slight tap on the forward curved surface of the floor plate may be necessary to seat the catch into position.
6. The magazine is now ready for use.

PARTS, SERVICE, REPAIR AND QUESTIONS

If your Winchester rifle or shotgun should ever need service or repair, it is often best to utilize one of our Authorized Service Centers. In some cases it is appropriate to use the Winchester Rifles and Shotguns Service Center in

Arnold, Missouri. A list of Authorized Service Centers was included with your new firearm. If you need a new listing, contact us. We can help you determine the best place to service your firearm.

In order to avoid delays, it is important to never send your gun directly to our facility without direct authorization from one of our service specialists. This avoids possible delays in obtaining service. Contact us at (800) 322-4626 for details on how to receive service before sending your gun.

Parts listings, Service Center lists, service procedures, service/repair form and general product information are also found on the Web at: www.winchesterguns.com.

When returning your firearm for servicing, you must do the following:

1. Be sure it is completely unloaded.
2. Remove the scope or other optics.
3. Package it securely in a cardboard container.
4. Enclose a letter with your firearm that clearly describes the trouble experienced, the ammunition used and the repairs desired. Also include your name and a daytime phone number where you can be reached.
5. If convenient, send a copy of the letter to us separately.
6. Never return ammunition with your firearm. It is against postal and most commerce regulations.

PARTS, SERVICE, REPAIR STATUS
AND TECHNICAL QUESTIONS —

Winchester Rifles and Shotguns Parts & Service
3005 Arnold Tenbrook Road
Arnold, MO 63010-9406
(800) 322-4626 (toll free)

GENERAL PRODUCT AND HISTORICAL QUESTIONS —

Winchester Rifles and Shotguns
275 Winchester Avenue
Morgan, UT 84050-9333
(800) 945-5237 (toll free)

***CAUTION: PARTS ARE MADE FOR WINCHESTER BRAND
GUNS MANUFACTURED BY OR FOR WINCHESTER RIFLES
AND SHOTGUNS, AND SHOULD NOT BE USED IN OTHER
GUNS, EVEN THOUGH MODELS MAY BE SIMILAR.
IMPROPERLY FITTED PARTS MAY BE DANGEROUS.***

WEB SITE INFORMATION

Winchester Rifles and Shotguns offers you an information resource on the World Wide Web.

- List of authorized repair centers.
- Customer Service information.
- Firearm Service/Repair Form.
- Answers to many technical and historical questions.
- Links to helpful sites.

Go to: www.winchesterguns.com

Important instructions for the

Winchester® Wildcat® Bolt-Action Rifle

Customer Service Department (United States)

Winchester Rifles and Shotguns

275 Winchester Avenue

Morgan, Utah 84050-9333

Phone: (800) 945-5237

If you have any questions or comments regarding your new firearm, please feel free to write or call us. Use the space below to record information about your new firearm.

Model _____

Serial Number _____

Purchased From _____

Date of Purchase _____

Winchester trademarks licensed from Olin Corporation.

A00603/05572

Contents	Page
Gun Safety Warnings	1
General Description	2
General Operation	3
Terminology and Descriptions	3
Serial Number	6
Initial Cleaning/Oiling	6
Ammunition	6
Operation of the Safety	6
Installing/Removing the Bolt	8
Cocking Indicator	9
Magazine Capacity	9
Loading	9
Firing	11
Unloading	11
In the Case of a Misfire	12
Sight Adjustments	12
Mounting a Scope	14
Cleaning and Maintenance Suggestions	14
Bolt Maintenance	16
Magazine Maintenance	18
Parts, Service, Repair and Questions	19
Web Site Information	20

NOTES



WINCHESTER
RIFLES AND SHOTGUNS

Winchester Rifles and Shotguns

275 Winchester Avenue

Morgan, UT, U.S.A. 84050-9333

www.winchesterguns.com

Winchester trademarks licensed from Olin Corporation.