

FWD 4 Speed

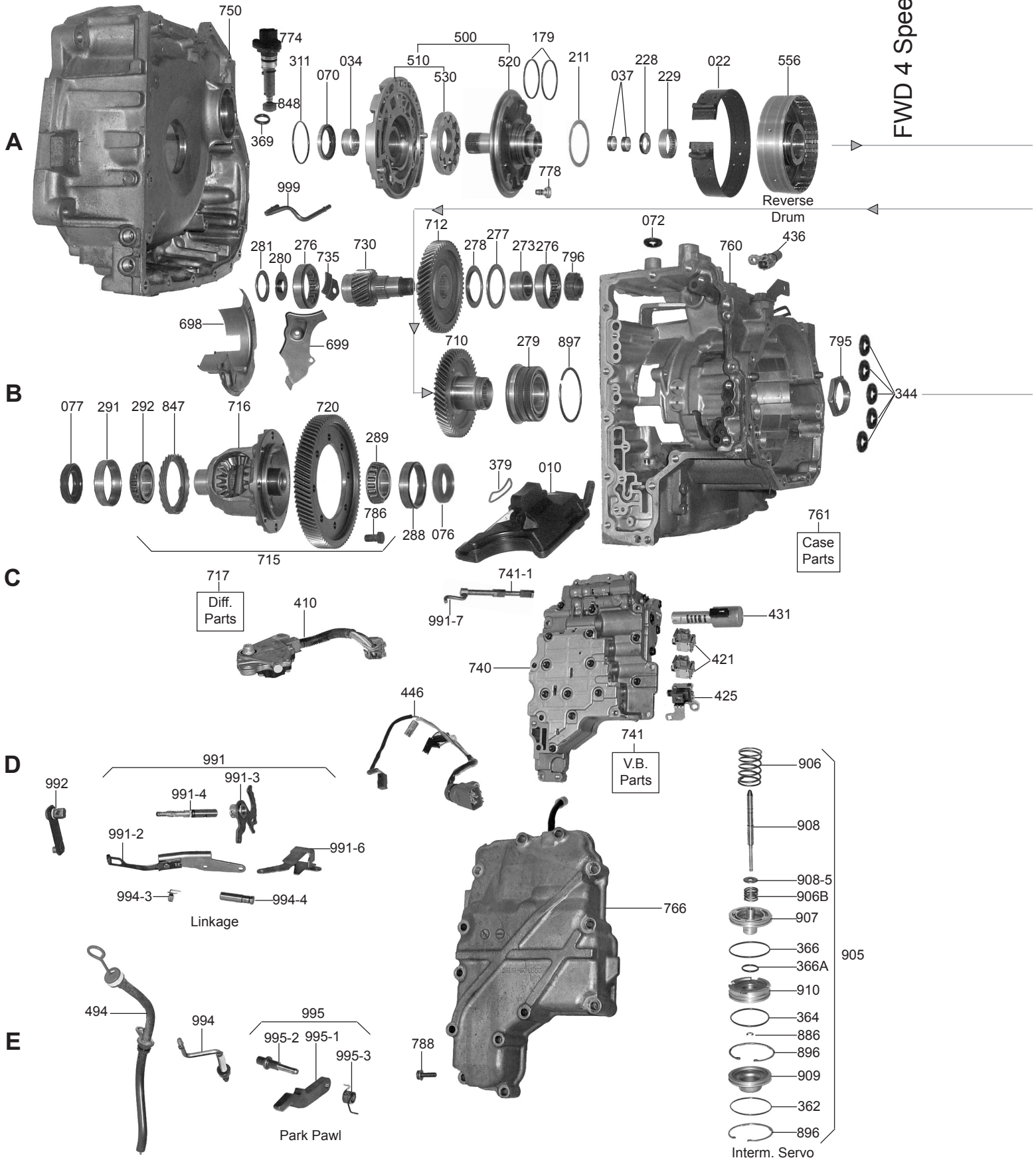

AISIN WARNER

FWD 4 Speed

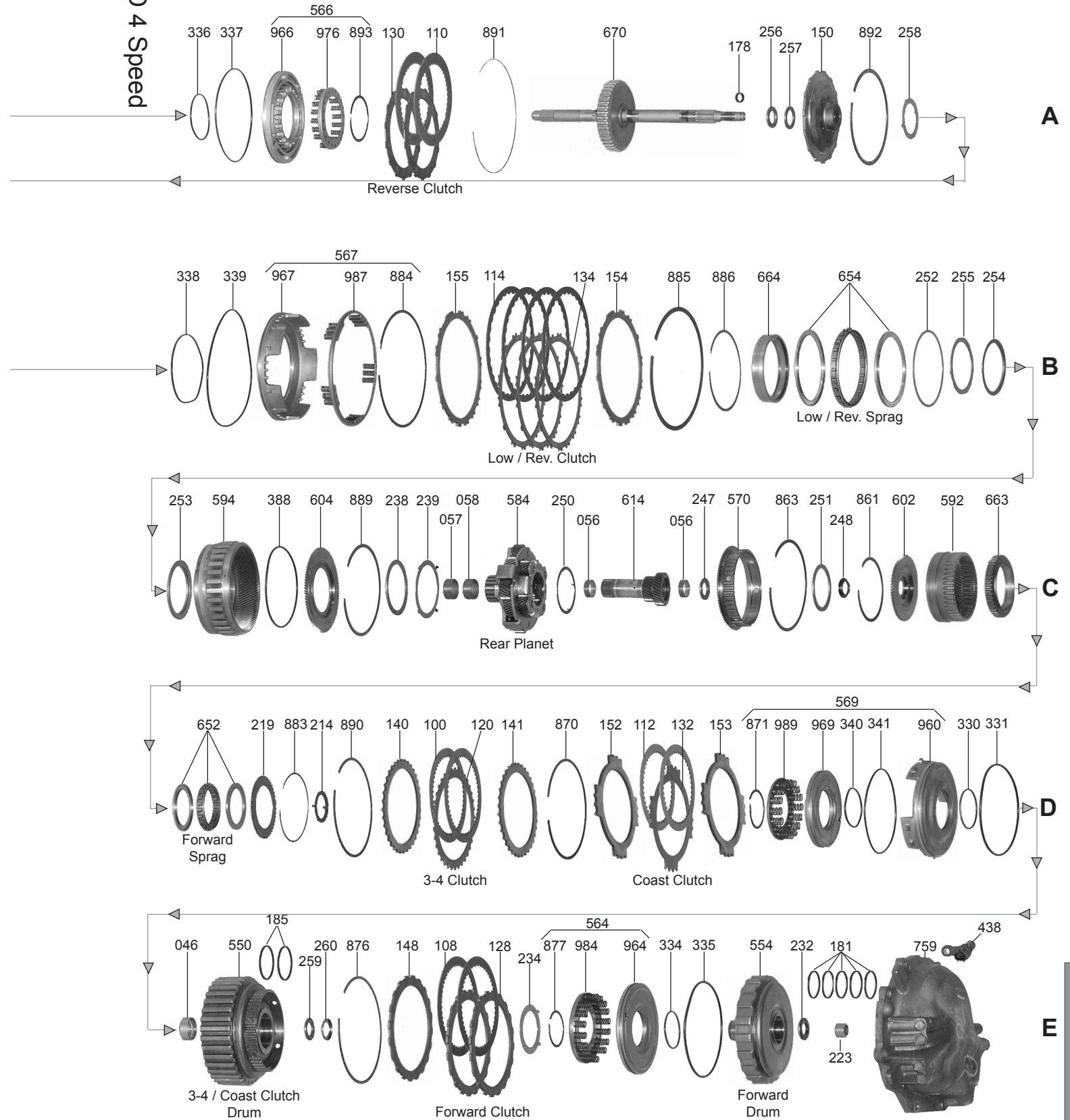

AISIN WARNER



60-40LE / -42LE / -41SN/ AF13 / AF17

FWD 4 Speed

PART #	OVERHAUL KITS	QTY.	REFERENCE #
121002A	Overhaul Kit, 60-40LE/60-42LE/60-41SN 1995-Up	1	
PART #	MASTER L/STEEL KIT	QTY.	REFERENCE #
121004A	Master L/Steels Kit, 60-40LE/60-42LE/60-41SN 1995-Up	1	
PART #	MASTER W/STEEL KIT	QTY.	REFERENCE #
121006A	Master W/Steels Kit, 60-40LE/60-42LE/60-41SN 1995-Up	1	
PART #	FILTER	QTY.	REFERENCE #
121010A	Filter, 60-40LE/60-42LE/60-41SN 1995-Up	1	26445-60G10
PART #	BANDS	QTY.	REFERENCE #
121022A	Band, 60-40LE Intermediate (Flex) 1993-Up	1	26971-60G10
PART #	BUSHINGS	QTY.	REFERENCE #
121030	Bushing Kit, 60-40LE 1993-Up	1	
PART #	METAL CLAD SEALS	QTY.	REFERENCE #
121070A	Seal, 60-40LE/41SN/42LE Pump 1995-Up	1	
121076A	Seal, 60-40LE/41SN/42LE Axle (Case Side) 1995-Up (Also Fits The Bell Housing Side 1995-E97)	1	
121077A	Seal, 60-40LE/41SN/42LE Axle (Bell Housing Side) 1995-E97 (Use 121076A)	1	
121077AA	Seal, 60-40LE/41SN/42LE Axle (Bell Housing Side) L1997-Up	1	
PART #	FRICTION CLUTCH	QTY.	REFERENCE #
121100A	Friction, 60-40LE 3-4 Clutch (.067") (51 Teeth) (Also Forward Clutch)	2-4	90444669
121108A	Use 121100A	2	90444669
121110A	Friction, 60-40LE Reverse Clutch (.075") (42 Teeth) (5.257"OD)	2	90444546
121112A	Friction, 60-40LE Coast Clutch (.707") (44 Teeth)	2	90444685
89114A	Friction, 60-40LE Low / Reverse Clutch (.067") (33 Teeth) (6 .302"OD)	4	90348808
121119A	Friction Module, AW60-40LE 1995-Up	1	
PART #	STEEL CLUTCH	QTY.	REFERENCE #
121120A	Steel, 60-40LE 3-4 Clutch (.071") (36 Teeth)	1	90444885
121128A	Steel, 60-40LE Forward Clutch (.069") (20 Teeth)	2	
121130A	Steel, 60-40LE Reverse Clutch (.071") (15 Lugs) (4.092"ID)	2	90444686
121132A	Steel, 60-40LE Coast Clutch (.072") (16 Teeth)	1	90444863
121134A	Steel, 60-40LE Low / Reverse Clutch (.071") (15 Teeth)	3	90444973
121139A	Steel Module, AW60-40LE 1995-Up	1	
PART #	CLUTCH PRESSURE PLATES	QTY.	REFERENCE #
121140AB	Pressure Plate, 60-40LE 3-4 Clutch (Top) (.142") (36 Teeth) Also Fits 3-4 Clutch Bottom	1-2	
121140AC	Pressure Plate, 60-40LE 3-4 Clutch (Top) (.150") (36 Teeth) Also Fits 3-4 Clutch Bottom	1-2	
121148AB	Pressure Plate, 60-40LE Forward Clutch (Top) (.142")	1	
121148AC	Pressure Plate, AW60-40LE Forward Clutch (top) (.150") (20 Teeth)	1	
121150A	Pressure Plate, 60-40LE Reverse Clutch With Splined Hub (15 Lugs) (.160" Thick At Edge)	1	
121152AB	Pressure Plate, 60-40LE Coast Clutch (Top) (.126") (16 Teeth) Also Fits Coast Clutch Bottom	1-2	
121152AE	Pressure Plate, 60-40LE Coast Clutch (Top) (.155") (16 Teeth) Also Fits Coast Clutch Bottom	1-2	
121155A	Pressure Plate, 60-40LE Low / Reverse Clutch (Top) (.42") (15 Teeth) Also Fits Low / Reverse Clutch Bottom	1-2	
PART #	OIL SEALING RINGS	QTY.	REFERENCE #
121175	Ring Kit, 60-40LE	1	

AISIN WARNER



60-40LE / -42LE / -41SN/ AF13 / AF17

FWD 4 Speed

PART #	WASHERS & BEARINGS	QTY.	REFERENCE #
121211A	Washer, 60-40LE Stator To Reverse Clutch Drum (.060") Plastic (1 Tab)	1	
121214A	Washer, 60-40LE Rear Ring Gear Hub To 3-4 Coast Clutch Drum (4 Tab) Plastic	1	
121219A	Race, 60-40LE Forward Sprag (40 Teeth) (2.460"ID) (.117" Thick)	1	
121223A	Caged Bearing, 60-40LE Rear Cover (BKM131715J)	1	
121228A	Bearing W/Races, 60-40LE Stator To Reverse Clutch Hub Input Shaft	1	24171-60G10
121229A	Caged Bearing, 60-40LE Stator To Reverse Drum (1.770"OD) (.468" Wide)	1	24733-60G10
121232A	Bearing W/Races, 60-40LE Forward Clutch Drum To Rear Cover (1.231"OD) (.639"ID) (.140" Thick)	1	
121234A	Washer, 60-40LE Forward Clutch Drum To 3-4 Coast Clutch Drum (4 Tab) Plastic	1	
121238A	Bearing W/Race, 60-40LE Planet To Front Ring Gear Hub (3.276"OD)	1	24912-60G10
121239A	Race, 60-40LE Planet To Front Ring Gear Hub (4 Tab)	1	24913-60G10
121247A	Bearing W/Race, 60-40LE Sun Gear To Rear Ring Gear Hub (1.270"OD) (.745"ID) Also Fits Forward Drum To Rear Ring Gear Hub	1-2	24935-60G10
121248A	Race, 60-40LE Sun Gear To Rear Ring Gear Hub	1	24955-60G10
121250A	Race, 60-40LE Planet To Rear Ring Gear Hub (4 Tab)	1	24916-60G10
121251A	Bearing W/Race, 60-40LE Planet To Rear Ring Gear Hub	1	24915-60G10
121252A	Race, 60-40LE Sprag To Front Ring Gear (Plastic) (.058" Thick)	1	
121253A	Bearing W/Race, 60-40LE Low / Reverse Inner Race To Front Planet (2.550"ID)	1	
121254A	Race, 60-40LE Low / Reverse Sprag Inner Race Spacer Bearing (2.690"ID)	1	
121255A	Spacer, 60-40LE Low / Reverse Inner Race To Bearing Race (.078")	1	
121256A	Bearing W/Race, 60-40LE Input Shaft To Reverse Clutch Pressure Plate (1.225"OD) (.738"ID) (.110" Thick)	1	
121257A	Race, 60-40LE Input Shaft To Reverse Clutch Pressure Plate (.079") (1.310"OD)	1	
121258A	Washer, 60-40LE Reverse Clutch Pressure Plate To Drive (.056" Thick) (4 Tabs)	1	
121259A	Use 121247A	1	
121260A	Race, 60-40LE Forward Drum To Rear Ring Gear Hub	1	
121273A	Inner Race, 60-40LE Pinion Shaft To Roller Bearing (06NU0716/20 KOYO)	1	
121276A	Roller Bearing, 60-40LE Pinion Shaft To Bell Housing (Cast # RNU090716-1) Also Fits Pinion Shaft To Case	1-2	24193-60G10
121277A	Bearing W/Race, 60-40LE Driven Transfer Gear To Case	1	24186-60G10
121278A	Race, 60-40LE Driven Transfer Gear To Case	1	24187-60G10
121279A	Ball Bearing, 60-40LE Drive Transfer Gear Support (2 Rolls Of Ball Bearings) (FBD49-1 G NSK)	1	
121280A	Race, 60-40LE Pinion Shaft To Bell Housing	1	24189-60G10
121281A	Bearing W/Race, 60-40LE Pinion Shaft To Bell Housing	1	24188-60G10
121288A	Cup Race, 60-40LE Differential Housing To Bell (Cast # TR080702J) Also Fits Differential Housing To Case # 291)	1-2	
121289A	Cone Bearing, 60-40LE Differential Housing To Bell Housing (Cast # TRO80702J) Also Fits Differential Housing To Case #292)	1-2	
121291A	Use 121288A	1	
121292A	Use 121289A	1	

PART #	ELECTRICAL COMPONENTS	QTY.	REFERENCE #
121410A	Switch, 60-40LE Neutral Safety (Tag # 60A030) (Tag #60A050) and 9 Blade Connector	1	37720-60G11
121421A	Solenoid, 60-40LE Shift	2	26426-60G11
121425A	Solenoid, 60-40LE Lock-Up	1	
121431A	Solenoid, 60-40LE Duty	1	26427-60G10
121436A	Sensor, 60-40LE Output Speed (Reads Off The Pinion Nut) (Grey)	1	26141-60G10
121438A	Sensor, 60-40LE Turbine Shaft (Reads Off The Forward Drum) (Black)	1	26143-60G10
121445A	Wire Harness, 60-40LE External	1	
121446A	Wire Harness, 60-40LE Internal (7 Prong Case Connector) With 5 2-Prong Connectors	1	

PART #	MISC. COMPONENTS	QTY.	REFERENCE #
121492A	Drain Plug, 60-40LE (Allen Head)	1	
121494A	Tube, 60-40LE Filler Tube With Dipstick	1	

PART #	HARD PARTS	QTY.	REFERENCE #
121500A	Complete Pump, 60-40LE (Cast Letter "C")	1	
121510A	Pump Body, 60-40LE With Gears (Cast Letter "C")	1	
121520A	Stator, 60-40LE (Cast Letter "C")	1	22820-60G10
121530A	Pump Gear Set, 60-40LE (.373" Thick)	1	
121550A	Drum, 60-40LE 3-4 Coast Clutch	1	
121554A	Drum, 60-40LE Forward Clutch (2 Clutch) (20 Teeth Steels)	1	
121556A	Drum, 60-40LE Reverse Clutch (2 Clutch)	1	
121564A	Piston Kit, 60-40LE Forward Clutch	1	

AISIN WARNER



60-40LE / -42LE / -41SN/ AF13 / AF17

FWD 4 Speed

PART #	HARD PARTS (Continued)	QTY.	REFERENCE #
121566A	Piston Kit, 60-40LE Reverse Clutch (For 2 Clutch Drum) (20 Spring Pockets) (18 Spring Retainer) (.031" Thick Snap Ring)	1	
121567A	Piston Kit, 60-40LE Low / Reverse Clutch (Cast # 3B) Piston 1.265" Thick x 6 1/8" OD (Retainer Is Same OD)	1	
121569A	Piston Kit, 60-40LE 3-4 Coast Clutch (16 Springs) (8 Lug Piston) (2.150"ID)	1	
121570A	Hub, 60-40LE 3-4 Clutch Hub	1	
121584A	Planet, 60-40LE (Uses A 26 Teeth / 35 Teeth Sun Gear)	1	24910-60G10
121592A	Ring Gear, 60-40LE Rear & Coast Clutch Hub	1	
121594A	Ring Gear, 60-40LE Front & Low/Reverse Clutch Hub (33 Outer Teeth) (2.270" Thick)	1	
121602A	Hub, 60-40LE Rear Ring Gear (.833"ID) (4 Holes)	1	
121604A	Hub, 60-40LE Front Ring Gear (98 Teeth) (2.615"ID)	1	
121614A	Sun Gear, 60-40LE (26 Teeth / 35 Teeth)	1	24931-60G10

PART #	SPRAGS & ONE WAY CLUTCHES	QTY.	REFERENCE #
121652A	Sprag, 60-40LE Forward With Brass Races (22 Lugs) (.434" Thick)	1	26672-60GT0
121654A	Sprag, 60-40LE Low / Reverse With Brass Races (24 Lugs) (.450" Thick)	1	

PART #	HARD PARTS (Continued)	QTY.	REFERENCE #
121663A	Outer Race, 60-40LE Forward Sprag (.573" Thick) (2.663"ID) (44 Teeth)	1	
121664A	Inner Race, 60-40LE Low / Reverse Sprag (.670" Thick) (3.835"OD)	1	
121670A	Shaft, 60-40LE Input With Reverse Clutch Hub (16 Converter Splines / 16 Rear Splines) 12 1/2" Long (44 Teeth) Clutch Hub	1	
121698A	Oil Baffle, 60-40LE Differential To Bell Housing (3 Bolt Tin)	1	
121699A	Oil Baffle, 60-40LE Differential To Case (3 Bolt Tin)	1	
121710A	Gear, 60-40LE Drive Transfer (53 Teeth)	1	24510-60G11
121712A	Gear, 60-40LE Driven Transfer (54 Teeth) Fits 121720A Drive Gear (With 12 Park Lugs)	1	
121716A	Differential Housing, 60-40LE With Spider Gears (.980"ID Axle Hole)	1	
121720A	Ring Gear, 60-40LE Differential (87 Teeth / 3 Groove) Fits 121730A Pinion	1	
121730A	Pinion, 60-40LE Shaft (23 Teeth / 3 Groove) Fits 121720A Ring Gear	1	
121735A	Oil Baffle, 60-40LE Pinion Shaft To Bell (1 Bolt)	1	
121740A	Valve Body, 60-40LE (4 Solenoid Type)	1	26500-65G30
121750A	Bell Housing, 60-40LE (Cast # 60A080)	1	
121759A	Rear Cover, 60-40LE (Cast # 35143-60A010) (10 Bolt) Aluminum	1	24731-60G10
121760A	Case, 60-40LE (Pink Tag With # 60-42LE)	1	24710-60G12
121766A	Pan, 60-40LE Side (Aluminum) Cast # 35151-60A050 (13 Bolt)	1	24751-60G11
121774A	Speed-O Housing, 60-40LE (With 20 Teeth Driven Gear) With 2 Prong Connector	1	
121778AK	Bolt Set, 60-40LE Holds Stator To Body (8 Pieces)	1	
121786AK	Bolt Set, 60-40LE Differential Ring Gear With Lock Tabs (8 Per Set)	1	
121795A	Nut, 60-40LE Hold Drive Transfer Gear To Bearing Support (2.158"OD At Flats)	1	
121796A	Nut, 60-40LE Pinion Shaft Roller Bearing (12 Teeth Rotor) Right Hand Threads	1	
121847A	Gear, 60-40LE Speed-O (23 Teeth) Plastic	1	
121861A	Snap Ring, 60-40LE Holds Rear Ring Gear To Hub	1	
121863A	Use 89889A	1	
121870A	Use 121890A	1	
121871A	Snap Ring, 60-40LE Coast Clutch Retainer (.040" Thick) (2.210"OD)	1	
121876A	Snap Ring, 60-40LE Holds Forward Clutch Pressure Plate In Drum	1	
121877A	Snap Ring, 60-40LE Forward Retainer (.040" Thick) (2.135"OD)	1	
121883A	Snap Ring, 60-40LE Holds Forward Sprag In Rear Ring Gear	1	
89884A	Snap Ring, 60-40LE Low/Reverse Retainer (6 5/8"OD) (.080" Thick)	1	
121885A	Snap Ring, 60-40LE Holds Low / Reverse Clutch Top Pressure Plate (.063")	1	
121886A	Snap Ring, 60-40LE Holds Low / Reverse Sprag In Front Ring Gear (.039" Thick) (4 13/16"OD)	1	
89889A	Snap Ring, 60-40LE 3-4 Clutch Hub To Front Ring Gear (Also Fits Front Hub To Front Ring Gear)	1-2	
121890A	Snap Ring, 60-40LE Holds 3-4 Clutch Pressure Plate In Drum (Also Holds Coast Clutch Pressure Plate In Drum)	1-2	
121891A	Snap Ring, 60-40LE Reverse Clutch Pressure Plate (Bottom) (.047" Thick)	1	
121892A	Snap Ring, 60-40LE Reverse Clutch Pressure Plate (Top) (.063") (5 5/8"OD)	1	
121893A	Snap Ring, 60-40LE Reverse Clutch Retainer (2.615"OD) (.031" Thick)	1	
121897A	Snap Ring, 60-40LE Holds Drive Gear In Case (3.260"OD) (.078" Thick) Waved	1	
121905A	Servo Assembly, 60-40LE Intermediate	1	
121991A	Linkage, 60-40LE Internal	1	
121992A	Shift Lever, 60-40LE External	1	
121994A	Park Pawl Actuator, 60-40LE	1	25920-60G10
121995A	Park Pawl Assembly, 60-40LE	1	
121999A	Oil Tube Set, 60-40LE	1	

AISIN WARNER



60-40LE / -42LE / -41SN/ AF13 / AF17

FWD 4 Speed

AISIN WARNER