

TECHNICAL INFORMATION



Glovebox Latch Closing Repair

No: 76/05/01/NAS
Ref:
Issue: 1
Date: 07/27/01

AFFECTED VEHICLE RANGE:

Discovery Series II (LT)

XA 900012 to XA 907212
XA 200412 to 1A 299999
1A 700000 to 1A 730216

SITUATION:

GLOVE BOX WILL NOT STAY CLOSED

The customer complains that the glove box will not stay closed or that it is difficult to close. The latch may also rattle. An oversize location hole for the latch assembly alignment pin may be allowing the latch to rotate, resulting in misalignment of the latch to the striker.

RESOLUTION:

POSITION AND SECURE THE LATCH ASSEMBLY

On customer complaint of the above, reposition and secure the latch assembly as described in the repair procedure below.

PARTS INFORMATION:

Locally sourced:

- Loctite® super glue gel

WARRANTY CLAIMS:

76.52.08..... Time 0.20 hrs.

Position and superglue glove box latch

FAULT CODE: C

Normal warranty policy and procedures apply.

Material allowance is included in labor operation.

TIB 76/05/01/NAS	CIRCULATE: TO	Service Mgr X	Warranty X	Workshop X	Body Shop X	Parts X
---------------------	------------------	------------------	---------------	---------------	----------------	------------

REPAIR PROCEDURE

POSITION AND ALIGN GLOVE BOX LATCH

1. Open the glove box.
2. Remove the single countersunk phillips screw securing the latch assembly to the glove box door.
3. Locate the upper hole in the glove box for the latch locating pin, (arrow in Figure 1).



WARNING: Follow manufacturer's warnings and cautions whenever using instant bonding materials to avoid personal injury.

4. Apply Loctite® super glue gel to the alignment hole.
5. Position the latch assembly against the outboard side of the locating holes.
6. Align latch square with the molded recess in the glove box.
7. Install and tighten the securing screw to a torque of **1 Nm (8.8 lbf.in.)**.



CAUTION: Verify latch movement only. Attempts to close the glove box before the super glue cures may move the latch.

8. Immediately confirm that the latch is square to the glove box and verify the latch operates freely, with the latching pawl returning fully to its rest position.
9. Allow a minimum of 5 minutes for adhesive to cure.
10. Test the glove box for satisfactory latch operation.

Figure 1

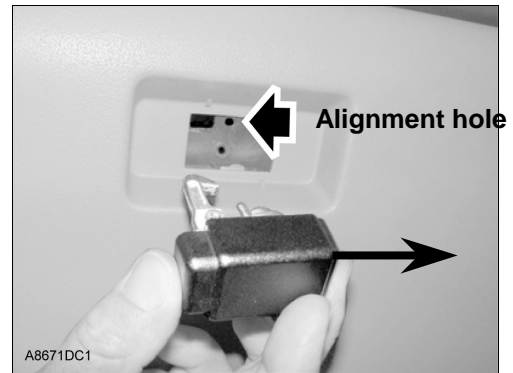

Move latch fully outboard