



Instructions

067-1064-99

TM 5000 DEMO AID

The TM 5000 Demo Aid is used as a test vehicle in the demonstration of the programmable TM 5000 instruments. It provides a variety of circuits configured by a six position dip switch to provide:

- a) Non-inverting AC or DC coupled variable gain amplifier.
- b) Free running triangle-squarewave generator at 200 kHz, 330 Hz or 1 Hz.
- c) Zero crossing comparator.
- d) 4-bit binary counter with preset inputs and LED display.
- e) ± 18 V overvoltage protection (crowbar) and reverse voltage protection diodes.

The ECB plugs directly into the PS 5010 front panel jacks or the PS 503A front panel jacks for power. To use the ECB with a PS 503A, remove banana jacks from J1041 and J1042 and install them at J2021 and J2022. The edge card connector mates with a flexible connector plugged into the 50M30 digital I/O card (part of the MI 5010).

Use 012-0532-00 (hex-con to BNC) cables for connecting the demo aid to demo instruments. Probe test points are also provided and labeled.

U3041, C3035, C2012 and C3011 with R3031 comprise an RC Integrator driven by U3031 in the comparator mode. U3041 output is sensed at junction of R2024, R2023 and R3023 by U3031 which switches its output to drive the integrator back. See Fig. 1 for switch settings. U3031 output is a squarewave with amplitude of $+V$ and $-V$. U3041 output is a triangle centered at 0 V.

Circuit Description

± 18 V Overvolt Protection Ckt

VR1022 turns on when +V_{in} exceeds +18 V. This provides turn on bias for Q1021 across R1021. Q1021 turn-on shorts +V to ground preventing overvoltage damage to other circuitry. -18 V operation is identical for VR2012, R1011, and Q1011. Diodes CR2022 and CR2012 clamp outputs if wrong polarity supply voltages are supplied.

U3031 Amplifier/Comparator

S3021-6, S3021-1, and S3021-2 configure U3031 and associated circuitry as a X10 AC or DC coupled Noninverting Amplifier or as a zero crossing comparator. See Fig. 1 for switch settings. R2022 provides 0 dB-30 dB gain adjustment for the amplifier.

U3041 RC Integrator

C3035, C2012 and C3011 with R3031 comprise an RC Integrator driven by U3031 in the comparator mode. U3041 output is sensed at junction of R2024, R2023 and R3023 by U3031 which switches its output to drive the integrator back. See Fig. 1 for switch settings. U3031 output is a squarewave with amplitude of +V and -V. U3041 output is a triangle centered at 0 V.

Q2032 TTL Level Translator

Q2032 is an emitter follower buffer. Signals applied to the base are clipped at +5 V and ground. Output is available at J3031.

U2031 Presettable Binary Counter

U2031 provides four bit binary count of input from Q2032. Pin 1 (CT/LD input) may be pulled low in order to latch input data (A, B, C, D) into output buffers QA, QB, QC, and QD before continuing count on input clock pin 8.

Q3042 Display Driver

Q3042 buffers TTL outputs from U2031 to drive LED's DS3051, DS3043, DS3042, DS3041. LED's are ON for a TTL HI output from U2031.

J2051 Edge Connector

J2051 is configured identical to the 50M30 DIO card for the MI5010. Outputs from the Binary Counter U2031 are connected as inputs to the 50M30. Outputs from the 50M30 are connected as inputs to the counter. The 16-bit I/O to the 50M30 card is configured as follows:

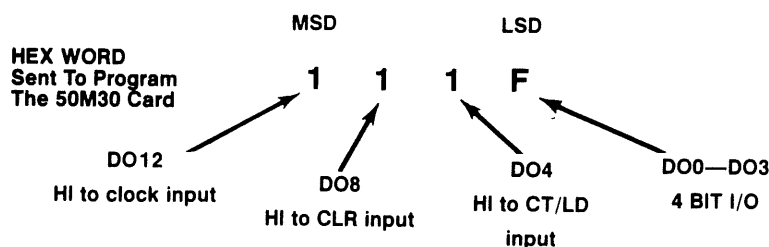

The optional cable accessory for the 50M30 may be used to connect the demo aid to the 50M30.

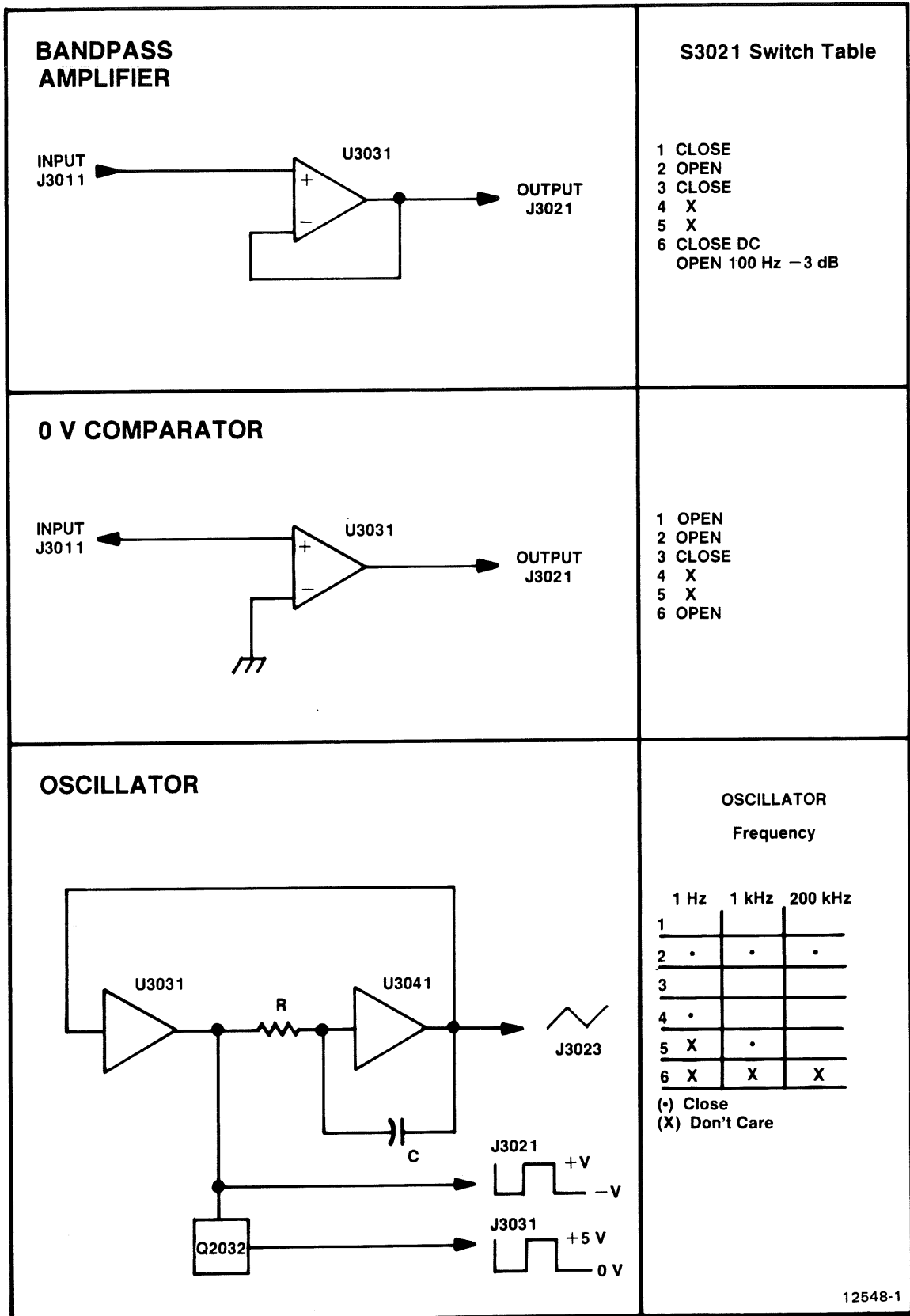
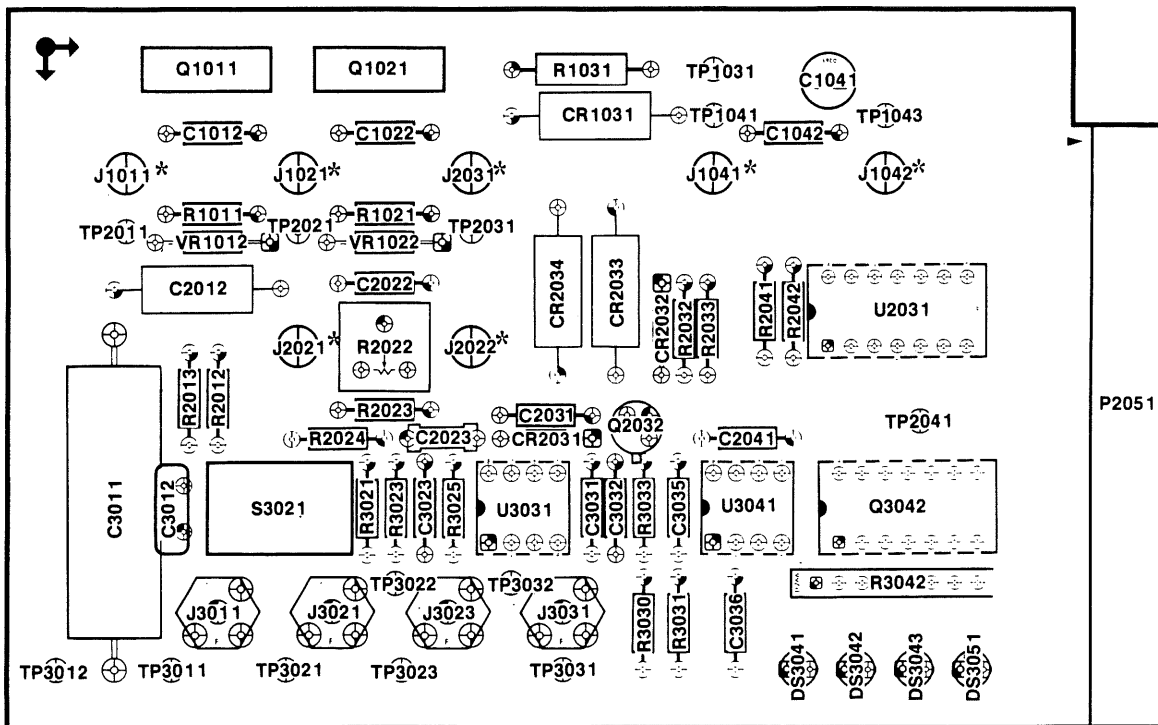

Fig. 1

12548-1



* Parts mounted on back

Demo Aid
R7887-01

REPLACEABLE ELECTRICAL PARTS

PARTS ORDERING INFORMATION

Replacement parts are available from or through your local Tektronix, Inc. Field Office or representative.

Changes to Tektronix instruments are sometimes made to accommodate improved components as they become available, and to give you the benefit of the latest circuit improvements developed in our engineering department. It is therefore important, when ordering parts, to include the following information in your order: Part number, instrument type or number, serial number, and modification number if applicable.

If a part you have ordered has been replaced with a new or improved part, your local Tektronix, Inc. Field Office or representative will contact you concerning any change in part number.

Change information, if any, is located at the rear of this manual.

LIST OF ASSEMBLIES

A list of assemblies can be found at the beginning of the Electrical Parts List. The assemblies are listed in numerical order. When the complete component number of a part is known, this list will identify the assembly in which the part is located.

CROSS INDEX-MFR. CODE NUMBER TO MANUFACTURER

The Mfr. Code Number to Manufacturer index for the Electrical Parts List is located immediately after this page. The Cross Index provides codes, names and addresses of manufacturers of components listed in the Electrical Parts List.

ABBREVIATIONS

Abbreviations conform to American National Standard Y1.1.

COMPONENT NUMBER (column one of the Electrical Parts List)

A numbering method has been used to identify assemblies, subassemblies and parts. Examples of this numbering method and typical expansions are illustrated by the following:

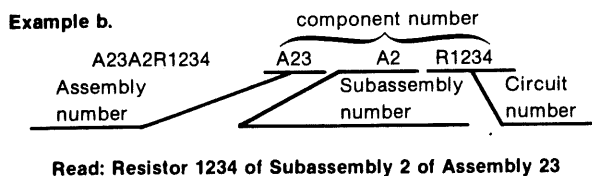
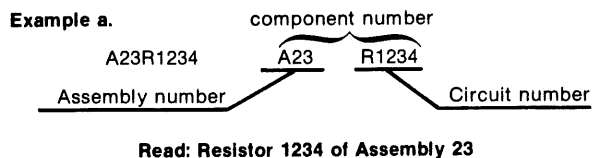

Only the circuit number will appear on the diagrams and circuit board illustrations. Each diagram and circuit board illustration is clearly marked with the assembly number. Assembly numbers are also marked on the mechanical exploded views located in the Mechanical Parts List. The component number is obtained by adding the assembly number prefix to the circuit number.

The Electrical Parts List is divided and arranged by assemblies in numerical sequence (e.g., assembly A1 with its subassemblies and parts, precedes assembly A2 with its subassemblies and parts).

Chassis-mounted parts have no assembly number prefix and are located at the end of the Electrical Parts List.

TEKTRONIX PART NO. (column two of the Electrical Parts List)

Indicates part number to be used when ordering replacement part from Tektronix.

SERIAL/MODEL NO. (columns three and four of the Electrical Parts List)

Column three (3) indicates the serial number at which the part was first used. Column four (4) indicates the serial number at which the part was removed. No serial number entered indicates part is good for all serial numbers.

NAME & DESCRIPTION (column five of the Electrical Parts List)

In the Parts List, an Item Name is separated from the description by a colon (:). Because of space limitations, an Item Name may sometimes appear as incomplete. For further Item Name identification, the U.S. Federal Cataloging Handbook H6-1 can be utilized where possible.

MFR. CODE (column six of the Electrical Parts List)

Indicates the code number of the actual manufacturer of the part. (Code to name and address cross reference can be found immediately after this page.)

MFR. PART NUMBER (column seven of the Electrical Parts List)

Indicates actual manufacturers part number.

CROSS INDEX—MFR. CODE NUMBER TO MANUFACTURER

Mfr. Code	Manufacturer	Address	City, State, Zip
00779	AMP, INC.	P O BOX 3608	HARRISBURG, PA 17105
01121	ALLEN-BRADLEY COMPANY	1201 2ND STREET SOUTH	MILWAUKEE, WI 53204
01295	TEXAS INSTRUMENTS, INC., SEMICONDUCTOR GROUP	P O BOX 5012, 13500 N CENTRAL EXPRESSWAY	DALLAS, TX 75222
02735	RCA CORPORATION, SOLID STATE DIVISION	ROUTE 202	SOMERVILLE, NY 08876
03508	GENERAL ELECTRIC COMPANY, SEMI-CONDUCTOR PRODUCTS DEPARTMENT	ELECTRONICS PARK	SYRACUSE, NY 13201
04222	AVX CERAMICS, DIVISION OF AVX CORP.	P O BOX 867, 19TH AVE. SOUTH	MYRTLE BEACH, SC 29577
04713	MOTOROLA, INC., SEMICONDUCTOR PROD. DIV.	5005 E MCDOWELL RD, PO BOX 20923	PHOENIX, AZ 85036
19396	ILLINOIS TOOL WORKS, INC. PAKTRON DIV.	900 FOLLIN LANE, SE	VIENNA, VA 22180
27014	NATIONAL SEMICONDUCTOR CORP.	2900 SEMICONDUCTOR DR.	SANTA CLARA, CA 95051
32997	BOURNS, INC., TRIMPOT PRODUCTS DIV.	1200 COLUMBIA AVE.	RIVERSIDE, CA 92507
50522	MONSANTO CO., ELECTRONIC SPECIAL PRODUCTS	3400 HILLVIEW AVENUE	PALO ALTO, CA 94304
55680	NICHICON/AMERICA/CORP.	6435 N PROESEL AVENUE	CHICAGO, IL 60645
56289	SPRAGUE ELECTRIC CO.	87 MARSHALL ST.	NORTH ADAMS, MA 01247
72982	ERIE TECHNOLOGICAL PRODUCTS, INC.	644 W. 12TH ST.	ERIE, PA 16512
75042	TRW ELECTRONIC COMPONENTS, IRC FIXED RESISTORS, PHILADELPHIA DIVISION	401 N. BROAD ST.	PHILADELPHIA, PA 19108
80009	TEKTRONIX, INC.	P O BOX 500	BEAVERTON, OR 97077

Replaceable Electrical Parts—TM5000 Demo Aid

Ckt No.	Tektronix Part No.	Serial/Model No. Eff	Dscont	Name & Description	Mfr Code	Mfr Part Number
	670-7505-00			CKT BOARD ASSY:DEMO AID	80009	670-7505-00
C1012	281-0775-00			CAP.,FXD,CER DI:0.1UF,20%,50V	72982	8005D9AABZ5U104M
C1022	281-0775-00			CAP.,FXD,CER DI:0.1UF,20%,50V	72982	8005D9AABZ5U104M
C1041	290-0920-00			CAP.,FXD,ELCTLT:33UF,+50-10%,35V	55680	35ULB33V-T
C1042	281-0775-00			CAP.,FXD,CER DI:0.1UF,20%,50V	72982	8005D9AABZ5U104M
C2012	285-1101-00			CAP.,FXD,PLSTC:0.022UF,10%,200V	19396	223K02PT485
C2022	281-0861-00			CAP.,FXD,CER DI:270PF,5%,50V	04222	GC105A271J
C2023	281-0619-00			CAP.,FXD,CER DI:1.2PF,+/-0.1PF,200V	72982	374000COK0129B
C2031	281-0785-00			CAP.,FXD,CER DI:68PF,10%,100V	72982	8035D2AADC0G680K
C2041	281-0775-00			CAP.,FXD,CER DI:0.1UF,20%,50V	72982	8005D9AABZ5U104M
C3011	290-0764-00			CAP.,FXD,ELCTLT:5UF,+50-10%,100V	56289	500D142
C3012	283-0212-00			CAP.,FXD,CER DI:2UF,20%,50V	72982	8141N064Z5U205M
C3023	281-0861-00			CAP.,FXD,CER DI:270PF,5%,50V	04222	GC105A271J
C3031	281-0775-00			CAP.,FXD,CER DI:0.1UF,20%,50V	72982	8005D9AABZ5U104M
C3032	281-0775-00			CAP.,FXD,CER DI:0.1UF,20%,50V	72982	8005D9AABZ5U104M
C3035	281-0762-00			CAP.,FXD,CER DI:27PF,20%,100V	72982	8035D9AADC0G270M
C3036	281-0775-00			CAP.,FXD,CER DI:0.1UF,20%,50V	72982	8005D9AABZ5U104M
CR1031	152-0198-00			SEMICONV DEVICE:SILICON,200V,3A	03508	1N5624
CR2031	152-0141-02			SEMICONV DEVICE:SILICON,30V,150MA	01295	1N4152R
CR2032	152-0141-02			SEMICONV DEVICE:SILICON,30V,150MA	01295	1N4152R
CR2033	152-0198-00			SEMICONV DEVICE:SILICON,200V,3A	03508	1N5624
CR2034	152-0198-00			SEMICONV DEVICE:SILICON,200V,3A	03508	1N5624
DS3041	150-1014-00			LAMP,LED:RED,50MA	50522	MV5054-1
DS3042	150-1014-00			LAMP,LED:RED,50MA	50522	MV5054-1
DS3043	150-1014-00			LAMP,LED:RED,50MA	50522	MV5054-1
DS3051	150-1014-00			LAMP,LED:RED,50MA	50522	MV5054-1
Q1011	151-0515-01			SCR:SILICON	04713	2N4441
Q1021	151-0515-01			SCR:SILICON	04713	2N4441
Q2032	151-0188-00			TRANSISTOR:SILICON,PNP	04713	SPS6868K
Q3042	156-0281-00			MICROCIRCUIT,LI:4 TRANSISTOR ARRAY	02735	CA3725
R1011	315-0102-00			RES.,FXD,CMPSN:1K OHM,5%,0.25W	01121	CB1025
R1021	315-0102-00			RES.,FXD,CMPSN:1K OHM,5%,0.25W	01121	CB1025
R1031	308-0793-00			RES.,FXD,WW:0.51 OHM,5%,1 W	75042	BW20 .51 OHM 5%
R2012	315-0102-00			RES.,FXD,CMPSN:1K OHM,5%,0.25W	01121	CB1025
R2013	315-0512-00			RES.,FXD,CMPSN:5.1K OHM,5%,0.25W	01121	CB5125
R2022	311-1235-00			RES.,VAR,NONWIR:100K OHM,20%,0.50W	32997	3386F-T04-104
R2023	315-0243-00			RES.,FXD,CMPSN:24K OHM,5%,0.25W	01121	CB2435
R2024	315-0103-00			RES.,FXD,CMPSN:10K OHM,5%,0.25W	01121	CB1035
R2032	315-0511-00			RES.,FXD,CMPSN:510 OHM,5%,0.25W	01121	CB5115
R2033	315-0101-00			RES.,FXD,CMPSN:100 OHM,5%,0.25W	01121	CB1015
R2041	315-0102-00			RES.,FXD,CMPSN:1K OHM,5%,0.25W	01121	CB1025
R2042	315-0102-00			RES.,FXD,CMPSN:1K OHM,5%,0.25W	01121	CB1025
R3021	315-0512-00			RES.,FXD,CMPSN:5.1K OHM,5%,0.25W	01121	CB5125
R3023	315-0243-00			RES.,FXD,CMPSN:24K OHM,5%,0.25W	01121	CB2435
R3025	315-0511-00			RES.,FXD,CMPSN:510 OHM,5%,0.25W	01121	CB5115
R3030	315-0101-00			RES.,FXD,CMPSN:100 OHM,5%,0.25W	01121	CB1015
R3031	315-0823-00			RES.,FXD,CMPSN:82K OHM,5%,0.25W	01121	CB8235
R3033	315-0512-00			RES.,FXD,CMPSN:5.1K OHM,5%,0.25W	01121	CB5125
R3042	307-0677-00			RES,NTWK,FXD FI:4,56 OHM,2%,0.2W	01121	208B560
S3021	260-1589-00			SWITCH,PUSH:(6)SPST,0.1A,5V	00779	435166-4
TP1031	214-0579-00			TERM,TEST POINT:BRS CD PL	80009	214-0579-00
TP1041	214-0579-00			TERM,TEST POINT:BRS CD PL	80009	214-0579-00
TP1043	214-0579-00			TERM,TEST POINT:BRS CD PL	80009	214-0579-00
TP2011	214-0579-00			TERM,TEST POINT:BRS CD PL	80009	214-0579-00

Replaceable Electrical Parts—TM5000 Demo Aid

Ckt No.	Tektronix Part No.	Serial/Model No. Eff	Dscont	Name & Description	Mfr Code	Mfr Part Number
TP2021	214-0579-00			TERM, TEST POINT: BRS CD PL	80009	214-0579-00
TP2031	214-0579-00			TERM, TEST POINT: BRS CD PL	80009	214-0579-00
TP2041	214-0579-00			TERM, TEST POINT: BRS CD PL	80009	214-0579-00
TP3011	214-0579-00			TERM, TEST POINT: BRS CD PL	80009	214-0579-00
TP3012	214-0579-00			TERM, TEST POINT: BRS CD PL	80009	214-0579-00
TP3021	214-0579-00			TERM, TEST POINT: BRS CD PL	80009	214-0579-00
TP3022	214-0579-00			TERM, TEST POINT: BRS CD PL	80009	214-0579-00
TP3023	214-0579-00			TERM, TEST POINT: BRS CD PL	80009	214-0579-00
TP3031	214-0579-00			TERM, TEST POINT: BRS CD PL	80009	214-0579-00
TP3032	214-0579-00			TERM, TEST POINT: BRS CD PL	80009	214-0579-00
U2031	156-0142-00			MICROCIRCUIT, DI: 50 MHZ PRESETTABLE BIN CNTR	80009	156-0142-00
U3031	156-0742-00			MICROCIRCUIT, LI: OPERATIONAL AMPLIFIER	27014	LM318N
U3041	156-0742-00			MICROCIRCUIT, LI: OPERATIONAL AMPLIFIER	27014	LM318N
VR1012	152-0590-00			SEMICONV DEVICE: ZENER, 18V, 5% AT 7MA	80009	152-0590-00
VR1022	152-0590-00			SEMICONV DEVICE: ZENER, 18V, 5% AT 7MA	80009	152-0590-00

REPLACEABLE MECHANICAL PARTS

PARTS ORDERING INFORMATION

Replacement parts are available from or through your local Tektronix, Inc. Field Office or representative.

Changes to Tektronix instruments are sometimes made to accommodate improved components as they become available, and to give you the benefit of the latest circuit improvements developed in our engineering department. It is therefore important, when ordering parts, to include the following information in your order: Part number, instrument type or number, serial number, and modification number if applicable.

If a part you have ordered has been replaced with a new or improved part, your local Tektronix, Inc. Field Office or representative will contact you concerning any change in part number.

Change information, if any, is located at the rear of this manual.

SPECIAL NOTES AND SYMBOLS

- X000 Part first added at this serial number
- 00X Part removed after this serial number

FIGURE AND INDEX NUMBERS

Items in this section are referenced by figure and index numbers to the illustrations.

INDENTATION SYSTEM

This mechanical parts list is indented to indicate item relationships. Following is an example of the indentation system used in the description column.

- ```

1 2 3 4 5 Name & Description
Assembly and/or Component
Attaching parts for Assembly and/or Component
 ---*---
Detail Part of Assembly and/or Component
Attaching parts for Detail Part
 ---*---
Parts of Detail Part
Attaching parts for Parts of Detail Part
 ---*---

```

Attaching Parts always appear in the same indentation as the item it mounts, while the detail parts are indented to the right. Indented items are part of, and included with, the next higher indentation. The separation symbol ---\*--- indicates the end of attaching parts.

**Attaching parts must be purchased separately, unless otherwise specified.**

## ITEM NAME

In the Parts List, an Item Name is separated from the description by a colon (:). Because of space limitations, an Item Name may sometimes appear as incomplete. For further Item Name identification, the U.S. Federal Cataloging Handbook H6-1 can be utilized where possible.

## ABBREVIATIONS

|       |                    |         |                       |          |                      |          |                 |
|-------|--------------------|---------|-----------------------|----------|----------------------|----------|-----------------|
| "     | INCH               | ELCTRN  | ELECTRON              | IN       | INCH                 | SE       | SINGLE END      |
| #     | NUMBER SIZE        | ELEC    | ELECTRICAL            | INCAND   | INCANDESCENT         | SECT     | SECTION         |
| ACTR  | ACTUATOR           | ELCTLT  | ELECTROLYTIC          | INSUL    | INSULATOR            | SEMICOND | SEMICONDUCTOR   |
| ADPTR | ADAPTER            | ELEM    | ELEMENT               | INTL     | INTERNAL             | SHLD     | SHIELD          |
| ALIGN | ALIGNMENT          | EPL     | ELECTRICAL PARTS LIST | LPHLDR   | LAMPHOLDER           | SHLDR    | SHOULDERED      |
| AL    | ALUMINUM           | EQPT    | EQUIPMENT             | MACH     | MACHINE              | SKT      | SOCKET          |
| ASSEM | ASSEMBLED          | EXT     | EXTERNAL              | MECH     | MECHANICAL           | SL       | SLIDE           |
| ASSY  | ASSEMBLY           | FIL     | FILLISTER HEAD        | MTG      | MOUNTING             | SLFLKG   | SELF-LOCKING    |
| ATTEN | ATTENUATOR         | FLEX    | FLEXIBLE              | NIP      | NIPPLE               | SLVGG    | SLEEVEING       |
| AWG   | AMERICAN WIRE GAGE | FLH     | FLAT HEAD             | NON WIRE | NOT WIRE WOUND       | SPR      | SPRING          |
| BD    | BOARD              | FLTR    | FILTER                | OBD      | ORDER BY DESCRIPTION | SQ       | SQUARE          |
| BRKT  | BRACKET            | FR      | FRAME or FRONT        | OD       | OUTSIDE DIAMETER     | SST      | STAINLESS STEEL |
| BRS   | BRASS              | FSTNR   | FASTENER              | OVH      | OVAL HEAD            | STL      | STEEL           |
| BRZ   | BRONZE             | FT      | FOOT                  | PH BRZ   | PHOSPHOR BRONZE      | SW       | SWITCH          |
| BSHG  | BUSHING            | FXD     | FIXED                 | PL       | PLAIN or PLATE       | T        | TUBE            |
| CAB   | CABINET            | GSKT    | GASKET                | PLSTC    | PLASTIC              | TERM     | TERMINAL        |
| CAP   | CAPACITOR          | HDL     | HANDLE                | PN       | PART NUMBER          | THD      | THREAD          |
| CER   | CERAMIC            | HEX     | HEXAGON               | PNH      | PAN HEAD             | THK      | THICK           |
| CHAS  | CHASSIS            | HEX HD  | HEXAGONAL HEAD        | PWR      | POWER                | TNSN     | TENSION         |
| CKT   | CIRCUIT            | HEX SOC | HEXAGONAL SOCKET      | RCPT     | RECEPTACLE           | TPG      | TAPPING         |
| COMP  | COMPOSITION        | HLCPS   | HELICAL COMPRESSION   | RES      | RESISTOR             | TRH      | TRUSS HEAD      |
| CONN  | CONNECTOR          | HLEXT   | HELICAL EXTENSION     | RGD      | RIGID                | V        | VOLTAGE         |
| COV   | COVER              | HV      | HIGH VOLTAGE          | RLF      | RELIEF               | VAR      | VARIABLE        |
| CPLG  | COUPLING           | IC      | INTEGRATED CIRCUIT    | RTNR     | RETAINER             | W/       | WITH            |
| CRT   | CATHODE RAY TUBE   | ID      | INSIDE DIAMETER       | SCH      | SOCKET HEAD          | WSHR     | WASHER          |
| DEG   | DEGREE             | IDENT   | IDENTIFICATION        | SCOPE    | OSCILLOSCOPE         | XFMR     | TRANSFORMER     |
| DWR   | DRAWER             | IMPLR   | IMPELLER              | SCR      | SCREW                | XSTR     | TRANSISTOR      |

CROSS INDEX—MFR. CODE NUMBER TO MANUFACTURER

| Mfr. Code | Manufacturer                                             | Address             | City, State, Zip     |
|-----------|----------------------------------------------------------|---------------------|----------------------|
| 73803     | TEXAS INSTRUMENTS, INC., METALLURGICAL<br>MATERIALS DIV. | 34 FOREST STREET    | ATTLEBORO, MA 02703  |
| 74970     | JOHNSON, E. F., CO.                                      | 299 10TH AVE. S. W. | WASECA, MN 56093     |
| 80009     | TEKTRONIX, INC.                                          | P O BOX 500         | BEAVERTON, OR 97077  |
| 83385     | CENTRAL SCREW CO.                                        | 2530 CRESCENT DR.   | BROADVIEW, IL 60153  |
| 98291     | SEAELECTRO CORP.                                         | 225 HOYT            | MAMARONECK, NY 10544 |

Replaceable Mechanical Parts—TM5000 Demo Aid

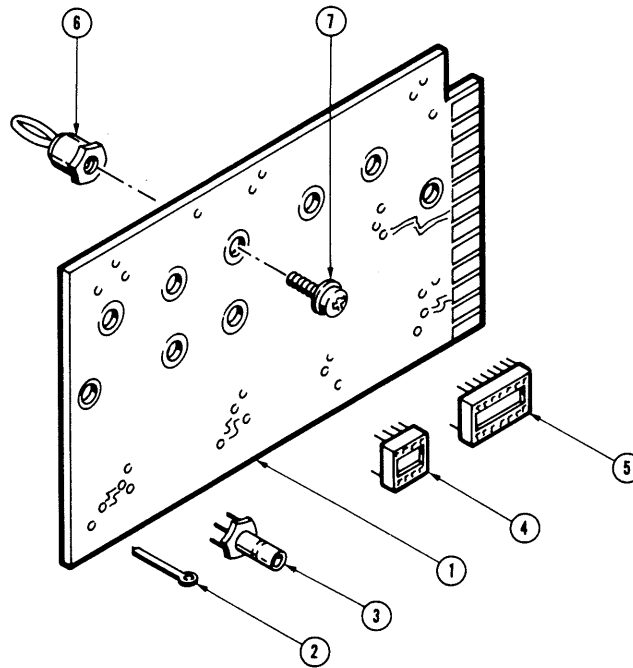

| Fig. & Index No. | Tektronix Part No. | Serial/Model No. Eff | Dscont | Qty | 1 | 2 | 3 | 4 | 5 | Name & Description                                                                                                                    | Mfr Code | Mfr Part Number |
|------------------|--------------------|----------------------|--------|-----|---|---|---|---|---|---------------------------------------------------------------------------------------------------------------------------------------|----------|-----------------|
| -1               | -----              | -----                |        | 1   |   |   |   |   |   | CKT BOARD ASSY: DEMO AID (SEE REPL)                                                                                                   |          |                 |
| -2               | -----              | -----                |        | 14  |   |   |   |   |   | TEST POINT: (SEE TP1031, TP1041, TP1043, TP2011, TP2021, TP2031, TP2041, TP3011, TP3012, TP3021, TP3022, TP3023, TP3031, TP3032 REPL) |          |                 |
| -3               | 131-0391-00        |                      |        | 4   |   |   |   |   |   | CONNECTOR, RCPT, :50 OHM, COAX, SNAP-ON MALE                                                                                          | 98291    | 51-051-0049     |
| -4               | 136-0514-00        |                      |        | 2   |   |   |   |   |   | SKT, PL-IN ELEC: MICROCIRCUIT, 8 DIP                                                                                                  | 73803    | CS9002-8        |
| -5               | 136-0269-02        |                      |        | 2   |   |   |   |   |   | SKT, PL-IN ELEC: MICROCIRCUIT, 14 DIP, LOW CLE                                                                                        | 73803    | CS9002-14       |
| -6               | 134-0013-00        |                      |        | 5   |   |   |   |   |   | PLUG, TIP: BANANA                                                                                                                     | 74970    | 108-753-17      |
| -7               | 211-0601-00        |                      |        | 5   |   |   |   |   |   | SCR, ASSEM WSHR: 6-32 X 0.312, DOUBLE SEMS                                                                                            | 83385    | OBD             |
|                  |                    |                      |        |     |   |   |   |   |   | (ATTACHING PARTS)                                                                                                                     |          |                 |
|                  |                    |                      |        |     |   |   |   |   |   | -----*                                                                                                                                |          |                 |
|                  |                    |                      |        |     |   |   |   |   |   | STANDARD ACCESSORIES                                                                                                                  |          |                 |
|                  | 061-2548-00        |                      |        | 1   |   |   |   |   |   | SHEET, TECHNICAL: INSTRUCTION                                                                                                         | 80009    | 061-2548-00     |

2-7

1

1

1

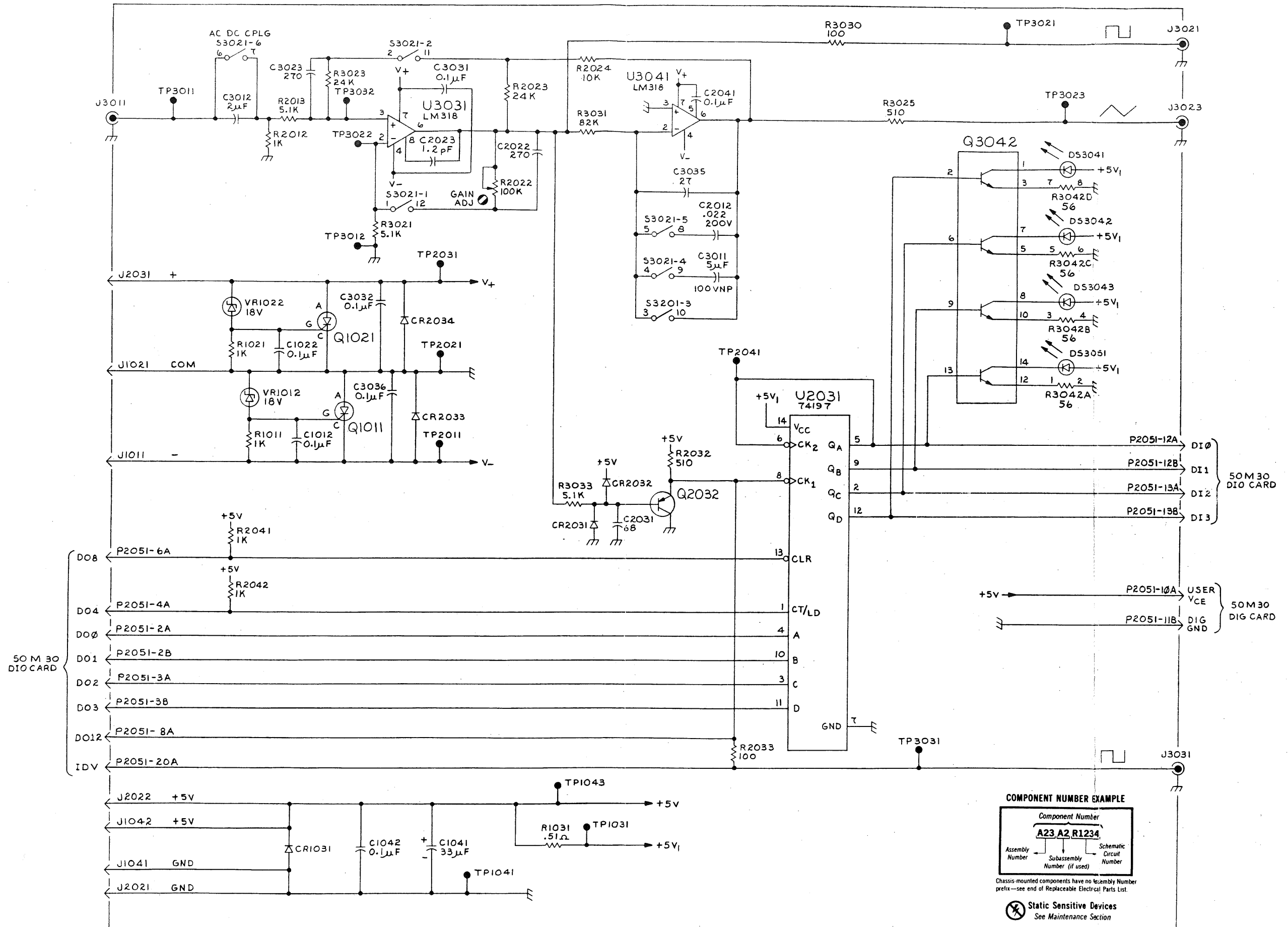

**COMPONENT NUMBER EXAMPLE**

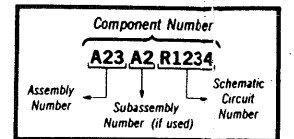

Chassis-mounted components have no Assembly Number prefix—see end of Replaceable Electrical Parts List.

**Static Sensitive Devices**  
See Maintenance Section