

Origin™ Grounding Cable Installation Note

The cable assembly shipped with this hardware contains a CrayLink™ interconnect cable and a grounding cable. When using this cable assembly, always attach the grounding cable first, then attach the CrayLink cable, as shown in Figure 1.

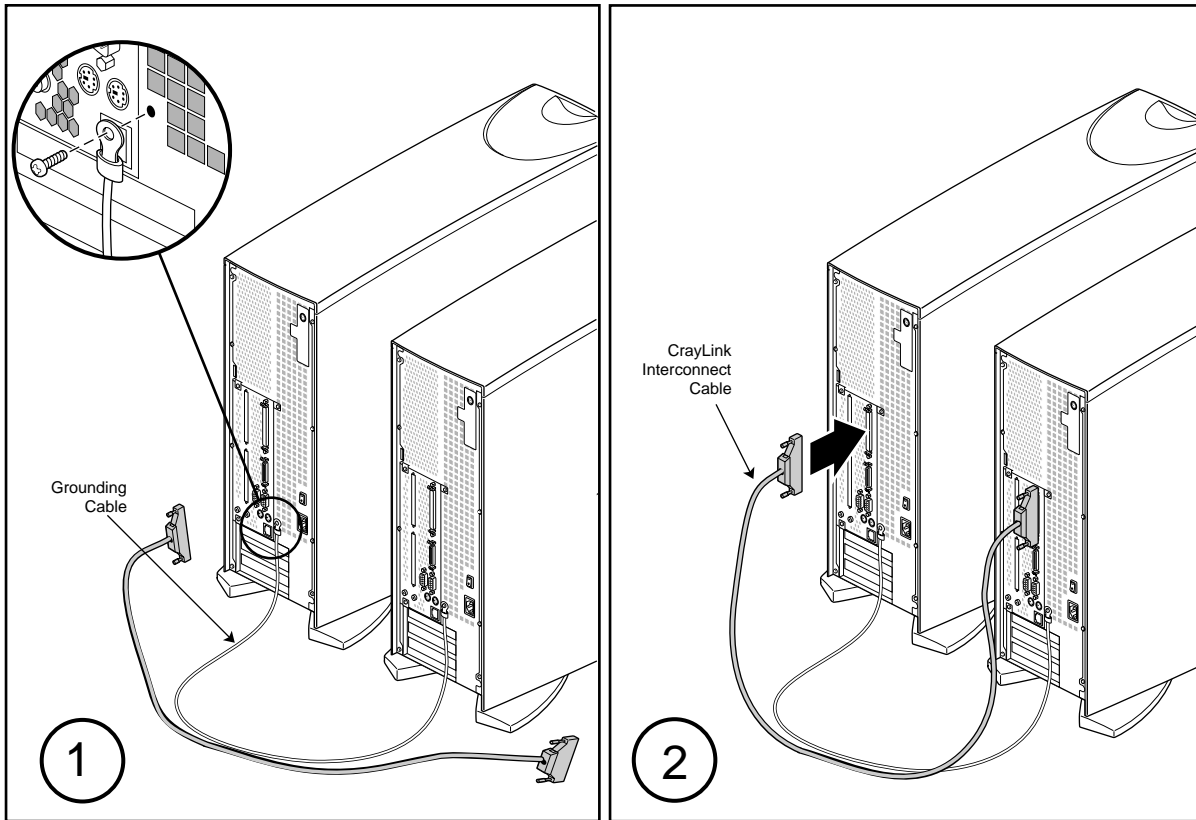

Figure 1 Attaching the Grounding Cable and CrayLink Interconnect Cable



Warning: You must attach the grounding cable before you connect components with a CrayLink interconnect cable. If you connect the CrayLink cable you may damage the hardware.

The grounding cable keeps the parts of the system connected by a CrayLink cable at the same ground reference voltage. More than a 500-millivolt difference in ground potential between the components of the system may cause damage to certain parts of the hardware.

©1997, Silicon Graphics, Inc. All rights reserved.

Silicon Graphics and the Silicon Graphics logo are registered trademarks of Silicon Graphics, Inc. Origin is a trademark of Silicon Graphics, Inc. and CrayLink is a trademark of Cray Research, Inc.

